

# G-Series User Manual

## Positive Displacement Gear Flow Meters



G004

G015

G045

G105

G240

G004HZ

G015HZ

G045HZ

**max**  
Precision Flow Meters

# Safety and Precautions



For flow meters approved for use in a hazardous environment, refer to the EXInstallSheet for installation instructions. Failure to follow the EXInstallSheet instructions shipped with the product may result in death or serious injury. For flow meters rated for ATEX, UL, or cUL Class 1, Div. 1 use in a hazardous environment, contact Max Machinery Sales at 707.433.2662 or [www.maxmachinery.com](http://www.maxmachinery.com).



Never run the meter dry or blow compressed air through the meter. Damage will occur.



Never steam clean the meter. Damage will occur. (Bypass or remove the meter if necessary).



Do not run water or aqueous solutions not approved by Max through your flow meter. Damage will occur.



Do not disassemble the meter. Damage may occur. No serviceable parts inside.



Do not over pressurize the meter. Damage may occur.



Do not remove the transmitter from the flow meter body unless advised by Max. Re-phasing the transmitter to the flow meter body via the Interface Software Kit is required to prevent measurement error. (isnt this what the gold comepnasation button is for?)



Do not apply excessive differential pressure across the flow meter. Damage will occur. See pressure drop curves for safe area operation.



Do not exceed maximum flow rate for the material viscosity. Damage will occur.



Do not allow materials to cure in the flow meter. If materials cannot be flushed from the meter, damage may occur.



Do not flow remelttable materials through the meter until fully liquefied. Solids may damage the meter.



Read the entire manual before installing and operating the meter.



Verify the fluid to be measured is compatible with the flow meter.



Filter your fluid to prevent damage from debris and foreign materials.



Install bypass plumbing around the flowmeter to allow for easier servicing and line purging/flushing without damaging the meter.



Follow all local regulations and your company safety procedures when installing, operating, servicing, and maintaining your flow meter.

# Table of Contents

Safety and Precautions ..... i

Table of Contents ..... ii

How It Works ..... 1

Installation Mechanical ..... 2

Mechanical Operation ..... 4

Installation Electrical..... 5

Electrical Quick Start ..... 6

Field Compensation of Transmitter .....10

LED Functions .....12

Specifications.....13

Dimensions .....19

Optional Heater Block..... 30

Charts ..... 31

Part Matrix.....33

Available Accessories.....35

Troubleshooting and Service Request .....36

Additional Information Available .....36

Max Machinery, Inc. (MMI) reserves the right to change product specifications without notice to improve performance, reliability, or manufacturability. MMI shall not be held liable for operational, technical, or editorial errors/omissions. Visit our web site for the latest version of this user manual.



## How It Works

Max G-Series Precision Flow Meters are positive displacement gear meters that are able to operate over a wide range of flow rates and fluid viscosities. High accuracy measurement is achieved through precision machined spur gears that move proportional to the flow. High resolution outputs are produced by measuring the rotation of the gears and converting the signals to analog or frequency outputs. Flows can be monitored from 0.5 cc/min up to 240 liters/min with fluid temperatures from -40°C to 225°C and pressure ratings of 6000 psi (414 bar) depending upon model. The industrial meter electronics are protected against water, dust, and most corrosive liquids. The 5-pin Turck connector provided is IP68. Additionally, IP66 rated explosion proof enclosures, combined with a choice of one-part and two-part, high temperature designs with remote electronics cover a wide range of application environments - from the laboratory to harsh industrial processes. Optional seal materials allow for different fluid compatibility.

Max Machinery, Inc. designs, manufactures, calibrates, and refurbishes high accuracy, high resolution, precision liquid flow meters under an ISO 9001:2015 certified quality management system. All Max Precision Flow Meters are tested and calibrated in our lab and provide measurements traceable to NIST. If your calibration certificate is lost or missing, contact MMI with your meter serial number for a copy.

## Installation - Mechanical

Your Max Flow Meter has been configured at the factory to be used out of the box based on your submitted application data. Plumb it, wire it, and use it. The following section will provide instructions on how to properly plumb your Max Flow Meter in the liquid lines of your application.

Use the “IN” port or follow the flow direction arrow markings for the primary flow direction. Install the meter on the discharge side of the pump whenever possible. Excessive vibration at the meter should be avoided.

**Orientation:** Preferred mounting orientation of the meter depends on meter type. The orientation optimizes air purging and/or minimizes heat transfer to the electronics. G-Series meters, especially when used with thick fluids, should mount with the transmitter on the side and the plumbing oriented vertical flow up. This mounting orientation prevents air in the system that can cause response delays and errors in measurement.

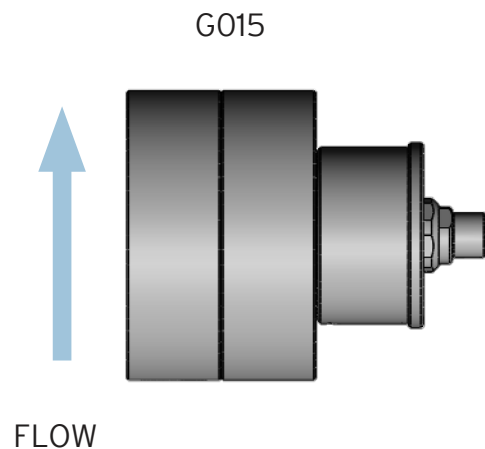

**NPT fittings:** Always use pipe sealant or pipe tape to install fittings, and leave the first thread of pipe exposed. Ensure the tape or sealant does not accidentally enter the meter.

**SAE fittings:** Always use process fluid compatible lubricant on the o-ring to attach the fitting to the meter.

## Installation - Mechanical

**Bypass Valves:** Install valves to allow system start-up, filter replacement, or flow meter removal without completely shutting the system down and draining the lines. See diagram.

Failure to use a bypass at start up may lead to flow meter damage due to debris, overspeeding the meter with air in the lines, and pressure shock due to initial line surges.

**Filtration:** A 10 micron filter is recommended on the inlet side of the meter for G004 and G015 flow meters. A 30 micron filter is recommended for G045, G105, and G240 flow meters. If measuring bi-directional flow, a filter should be installed on both sides of the flow meter. Materials with fibrous or non-abrasive particulate matter may need to be run without filters.

**Clean Plumbing:** Before installing the flow meter, the system lines shall be cleaned and free of all debris or manufacturing particulates. Purging lines with compressed air or steam are typical cleaning methods. Do not use compressed air or steam on the Max flow meter, damage will occur.

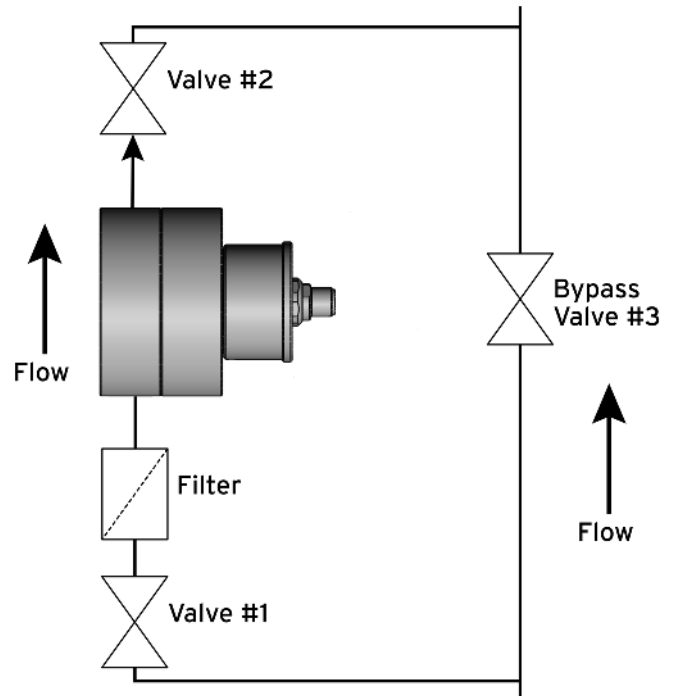

**High Temperatures:** Orient your meter so the transmitter is to the side or below to minimize heat transfer by convection from the flow meter to the transmitter. The transmitter is the most heat sensitive element in the system. Consult [page 8](#) for specific limits on fluid and ambient maximum temperatures. When operating in the upper temperature ranges, always insulate the meter but leave the transmitter housing exposed so it radiates heat. An optional heater block can be used on the flow meter to keep it at the fluid operating temperature. For substances solid at room temperature, a heater block may be required to keep material molten to flow through the meter.

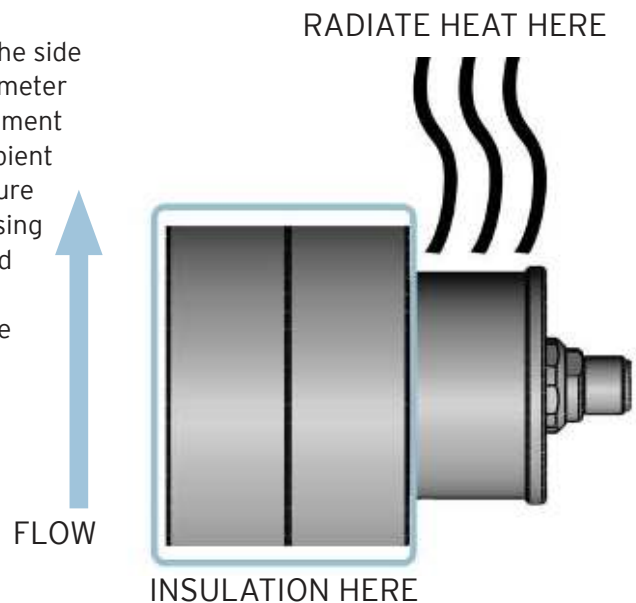

## Mechanical - Operation

Determine that the following parameters of your flow metering system are within the specifications for the specific meter being used:

- Maximum System Pressure (Specifications)
- Differential Pressure across meter (Pressure Drop Curves)
- Maximum Flow Rate (Pressure Drop Curves)
- Metered Fluid Temperature (Sales specification, transmitter specifications page 8)

If the metered fluid is greater than 28°C (80°F) over ambient, see the “High Temperature Start Up” section below.

With valves (#1) and (#2) closed, slowly open valve (#3) (bypass) to clear the lines of foreign particles and air. Slowly open the inlet valve (#1). Slowly open the outlet valve (#2). Completely close the bypass valve.

No routine maintenance, cleaning, or lubrication of the flow meter is required. A routine filter cleaning schedule should be established. The system should be shut down if abnormal noises occur or if unusual differential pressures across the meter are encountered.

**High Temperature Start Up:** For fluids above 82°C (150°F) based on 21°C (70°F) ambient, a special procedure is required to prevent thermal shock and permanent damage to the flow meter. The warm up time is determined by the equation below:

$$\begin{aligned} \text{TIME (minutes)} &= \frac{\text{connector size (inches)} \times (\text{operating temperature (°F)} - 125)}{10} \\ &\text{– OR –} \\ \text{TIME (minutes)} &= \frac{\text{connector size (inches)} \times (\text{operating temperature (°C)} - 52)}{10} \end{aligned}$$

Valves (#1) and (#2) must be closed. Open the bypass valve (#3) in gradual steps until the bypass piping is stabilized at operating temperature. Open valve (#1) slightly and allow the temperature to stabilize around the flow meter. Valve (#1) can then be opened completely.

Open valve (#2) slightly. The flow meter may make unusual noises or bind at this point. Leave the valve at this setting until normal meter operation occurs, at which point valve (#2) can be gradually opened all the way. Slowly close the bypass valve (#3).

## Installation - Electrical



**WARNING:** Electrical shock hazard. Serious or fatal injury may occur. Installation/Removal should only be completed by trained and authorized personnel.



**WARNING:** Refer to the EXInstall Sheet for proper installation in hazardous locations.



**CAUTION:** Verify transmitter output type (Analog or Frequency) before wiring. Inappropriate wiring could result in damaging the circuit.



**CAUTION:** Before opening/accessing the electronics lid, make sure the top of the meter and surrounding components are dry and no moisture or fluids can contact the electrical components. Non-warranty damage may occur.

Max G-Series Precision Flow Meters transmitters come from the factory pre-assembled to the mechanical metering component and configured to be used out of the box based on your submitted application data. Plumb it, wire it, and use it. The following section will describe how to properly wire your Max Flow Meter into the electronics of your application.

There are various combinations of transmitter components and outputs. These options include:

- Industrial or Hazardous Location Transmitter Housing
- Frequency or Analog Output Signal
- Uni-directional or Bi-directional Output Signal
- Standard, High Temperature, and Ultra High Temperature Housings

To determine what transmitter type you have, refer to the Max part number matrix on [pages 33-34](#) and decode your flow meter's part number.



**max**  
Precision Flow Meters



# Installation - Electrical

## Quick Start - No adjustments to factory settings

Your Max Flow Meter is connected to your process automation electronics via a 5-pin M12 Turck connector if an Industrial Transmitter or via a 5-pin connector within a Hazardous Location housing with a 1/2 inch conduit connection. Please refer to the EXInstall Sheet for proper installation of the wiring to the Hazardous Location housing.

Wire the 5-pin Turck cable to your process automation equipment in accordance with the diagrams below depending upon which transmitter type you purchased. Then connect the Turck cable to the Turck fitting on the Max Flow Meter.

Set your output reading on your process automation electronics to match the calibration sheet supplied with your flow meter.

You are ready to measure your liquid flow application.

## Start-up Instructions - Adjustments to Factory Settings Required

If you need to make adjustments to your Max Flow Meter prior to use, you will need to purchase and use the Max Machinery Interface Software Kit. This will allow you to change the flow meter output signal frequency or analog range to meet your application's equipment needs.

To access the port on the circuit board, unscrew the transmitter lid by hand. The transmitter lid has four thread paths. When reinstalling the lid, the cable may be misaligned. To realign the cable, remove the lid and rotate up to 180° and retighten using an alternate starting point. Tighten to compress the O-ring seal.

Max Flow Meters do not come with a visual interface, they must be connected to an electronic display, PLC/DAC/counter card or other process automation electronics to collect the data and display a visual reading.

You must determine if your process automation electronics have the capability to accept the high frequency output of the Max Flow Meter. If your system cannot accept the data at the pre-set frequency, then use the Max Machinery Interface Software Kit to adjust the frequency output to a lower setting that matches your system.

Refer to the Max Machinery Interface Software Kit Manual for instructions on how to change the flow meter output signal frequency or analog range to meet your application's equipment needs.

# Electrical Installation Instructions - 5-pin Turck Connectors

Applies only to transmitters with 5-pin, M12 style connectors. For hazardous location transmitters with 1/2 inch conduit connections, please refer to the EXInstall sheet.

## Frequency Output Transmitters (PN ending N/-)

|   | Turck® Connector |       |                         |
|---|------------------|-------|-------------------------|
|   | PCA Label        | Pin # | Mating Cable Wire Color |
|  |                  |       |                         |
| Power (+5 to 26 Vdc)  | V+               | 1     | Brown                   |
| Common  | Com              | 4     | Black                   |
| Pulse Output  | Ph A             | 2     | White                   |
| Output Phase B (Quad only)  | Ph B             | 5     | Grey                    |
| Case Ground   | Case             | 3     | Blue                    |



## Current Sinking Wiring (PN ending S/-)

A current sinking device uses the transmitter's transistor output to act as a switch. Positive DC voltage must be applied to the transmitter's output pin (#2). When the pulse output is triggered, this voltage is grounded to zero volts by the transmitter. Warning: Use a 5k ohm resistor to limit current if your system does not have other means to limit current into the transmitter.

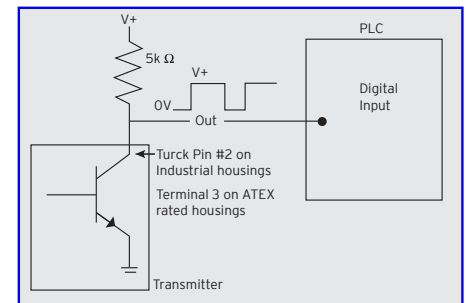

## Analog Current or Voltage Output Transmitters (PN ending A/-, B/-, C/-, or D/-)

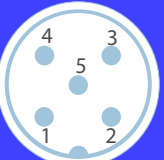
|   | Turck® Connector |       |                         |
|---|------------------|-------|-------------------------|
|   | PCA Label        | Pin # | Mating Cable Wire Color |
|  |                  |       |                         |
| Power *   | V+               | 1     | Brown                   |
| Common  | Com              | 4     | Black                   |
| Signal Output (+)   | Sig              | 5     | Grey                    |
| Signal Output (-)**   | Ret              | 2     | White                   |
| Case Ground   | Case             | 3     | Blue                    |



\* Analog transmitters with part numbers ending in A/- or C/- are 24Vdc power. Part numbers ending in B/- or D/- are 12Vdc power.

\*\* To minimize signal noise, analog output transmitters are fully isolated. If your PLC does not ground the negative signal input, there is a risk of a ground shift that could drive the signal out of the range of detection. To prevent this from occurring, install a 10k pull down resistor between Common and Signal Output (-).

## Electrical - Operating Information

Max Flow Meters require a fully isolated power supply to operate. Refer to the Max Machinery Interface Software Kit Manual for instructions on how to change the flow meter output signal frequency or analog range to meet your application's equipment needs.

Transmitters should not be removed from the flow meter for any field servicing or adjustments. The flow meter and transmitter must be shipped back to the factory for calibration or service as the complete serialized unit.

**Removal note:** If an industrial transmitter needs to be removed from the flow meter for installation, be sure to retighten the transmitter snugly in order to ensure proper sensor alignment. To remove, disconnect the Turck cable and unscrew the industrial transmitter. Use a wrench if necessary. To reattach the industrial transmitter, hand tighten only (~3 ft-lb). For Hazardous Location transmitters, refer to the EXInstall Sheet for proper installation.

**Moisture Seal Protection:** On all models, the housing is designed as a liquid and vapor-tight enclosure. There are O-ring seals at the lid and also the base of the housing in some models; these need to be fully seated. A properly sealed transmitter will prevent the formation of damaging moisture inside the housing. Industrial transmitters have Turck connectors sealed to the lid at the factory and are ready for use. There are no adjustments or servicing that require the connector to be removed from the transmitter lid. Hazardous Location transmitters have an NPT connection. Refer to the EXInstall Sheet for proper installation.

**Environmental:** The Industrial transmitters are rated to operate in the following fluid temperature ranges at ambient temperature ranges of -40°C to 80°C Standard and 110°C High and Ultra High Temperature Housings. With ambient temperature increases, the maximum fluid temperature at the flow meter is de-rated as shown in the charts below. Hazardous location transmitters have different ambient and fluid temperature ratings, refer to the EXInstall Sheet for proper installation.

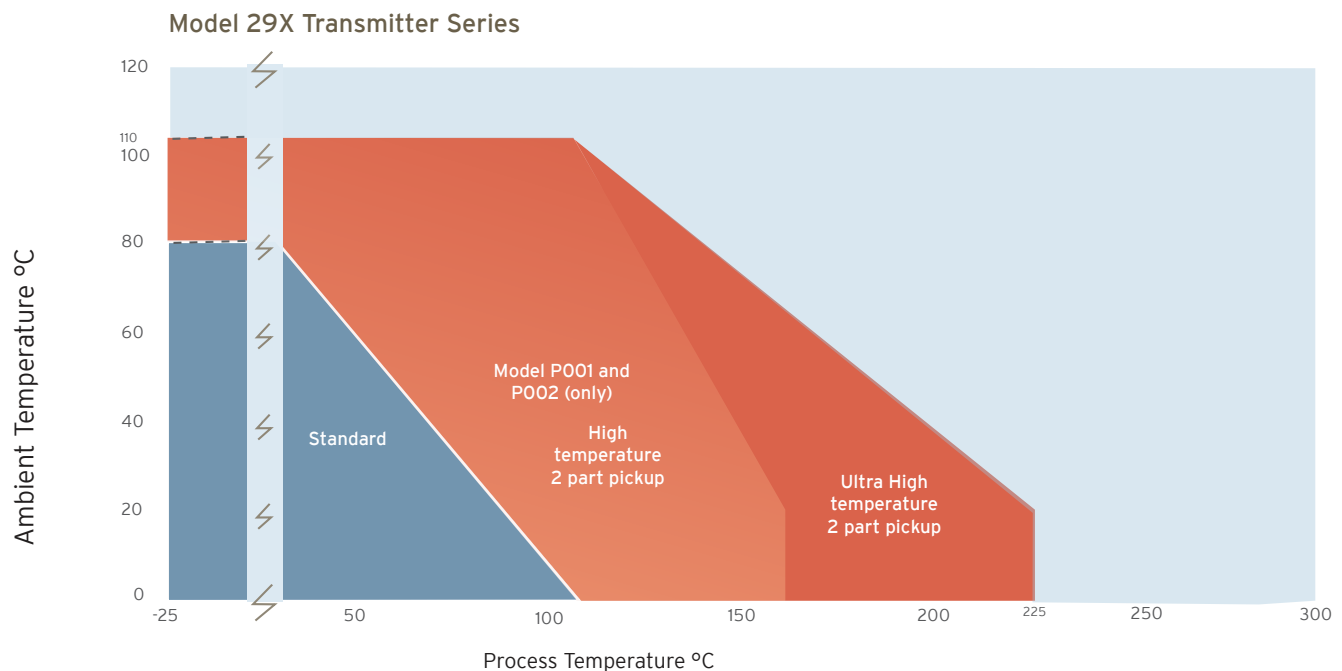

## High Temperature Instructions

Orient your meter so the transmitter is to the side or below to minimize heat transfer by convection from the flow meter to the transmitter. The transmitter is the most heat sensitive element in the system. Consult the table on [page 8](#) for specific limits on fluid and ambient maximum temperatures. When operating in the upper temperature ranges, always insulate the meter but leave the transmitter housing exposed so it radiates heat. An optional heater block can be used on the flow meter to keep it at the fluid operating temperature. For substances solid at room temperature, a heater block may be required to keep material molten to flow through the meter.

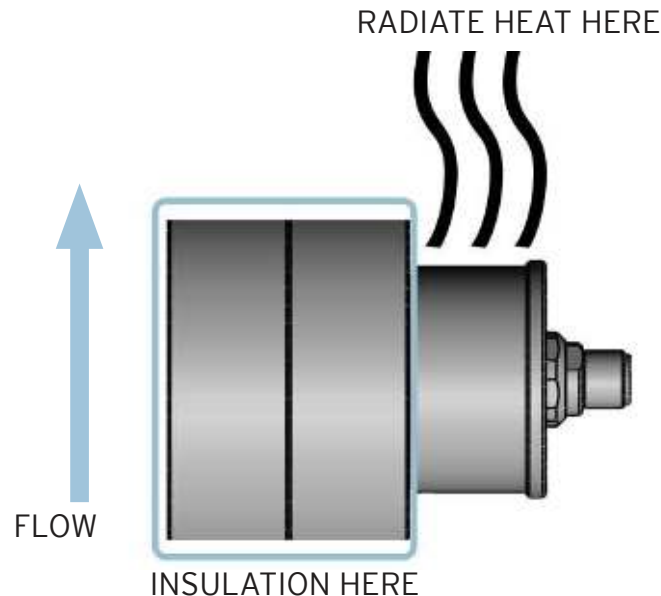

## Troubleshooting

### LED Rotation/Output Indicators

All Max transmitters incorporate an alternating red/green or blue/green LED to indicate magnet rotation in the meter. The color changes each 1/2 revolution of the meter. Additionally, when no flow signal is present, a rapidly flashing red light indicates the following errors:

Frequency (PN ending N/- or S/-):

Flashes 8x per second indicate magnet is not detected

Analog (PN ending A/-, B/-, C/-, D/-):

Flashes 2x per second indicate excessive temperature

Flashes 8x per second indicate magnet is not detected

Flashes 16x per second indicate a wiring fault in the output circuit

Note: There are no selections or adjustments on the circuit board. Setting changes are made through the Interface Software Kit (SFT-KIT-001), sold separately.

# Field Compensation of Transmitter

The transmitter LED on the circuit board indicates a functioning system when it is producing a pulse output or detecting magnet travel in the meter.

An alternating blue/green LED indicates that the circuit is detecting a magnet and provides an output signal.

A steady or flashing red LED indicates a problem with the transmitter PCA. Contact Max Machinery to have your flow meter refurbished.

The Compensation Algorithm adjusts for variations in Hall sensor and flow meter characteristics to provide a stable, undamped output frequency that accurately represents the instantaneous flow rate. This feature is factory set when the meter is assembled. If the transmitter PCA is replaced or reset, the compensation can be performed via the gold PCA button or through the software kit.

The only method of altering additional factory set parameters of the meter is through the Interface Software Kit, part number SFT-KIT-001. Pulse Output Scaling, Analog Output Limits and Scaling, Signal Filtering Options and Compensation settings are the adjustable variables.



**WARNING:** Electrical shock hazard. Serious or fatal injury may occur. Access should only be completed by trained and authorized personnel.



**CAUTION:** Before opening/accessing the electronics lid, make sure the top of the P234 meter and surrounding components are dry and no moisture or fluids can contact the electrical components. Non-warranty damage may occur.

Instructions to access the gold PCA button and software serial port:

- Unscrew the captured philips head screws on the electronics lid.
- Remove and set aside the lid with o-ring seal.
- Optional: follow instructions for SFT-KIT-001 to connect to software serial port.
- Follow field compensation instructions on [page 11](#).
- To reinstall, ensure the o-ring seal is firmly seated. Assembly is then the reverse of disassembly.

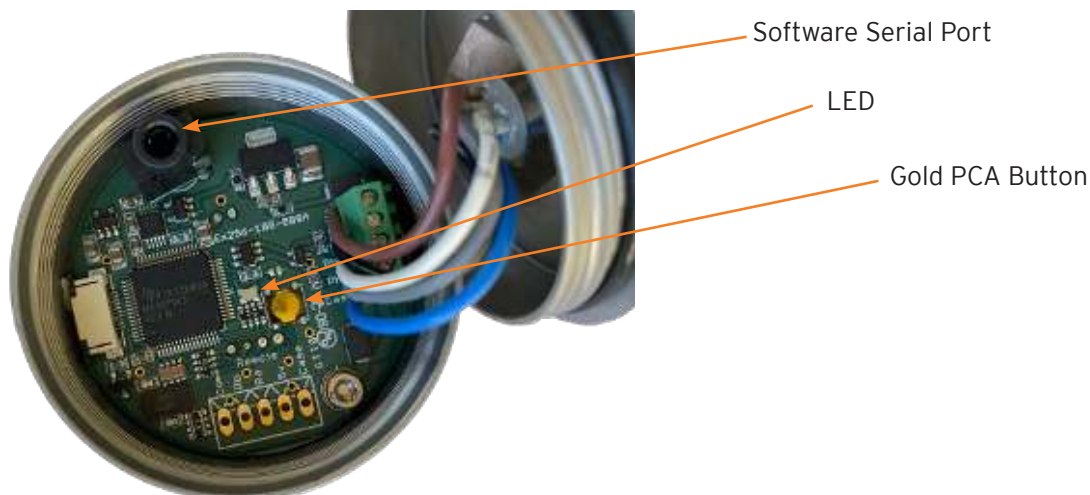

## Field Compensation of Transmitter Continued

When a transmitter PCA is replaced or reset in the field, the compensation routine should be performed to optimize the performance of the system. This routine requires a steady flow rate for the flow meter model as shown in Table A below. The flow meter being compensated must not be used for system flow rate feedback control during this process. The transmitter output is disabled during the compensation routine.

If you are unable to run a stable flow in the field, send your meter in to Max Machinery for calibration.

The compensation routine is as follows:

1. Place your system in 'manual' mode or run in 'open loop' mode with no flow meter feedback control. Max transmitter output shuts off during field compensation routine. Loss of signal to 'closed loop control' modes can affect the flow stabilization of the system and the compensation of the Max meter.
2. Stabilize the flow rate for your flow meter model as shown in Table A below.
3. Activate the compensation routine:
  - A - When using the software via the serial port connection, select 'field compensation' in the software.OR
  - B - If NOT using software, push the Gold PCA Button using a non-conductive tool.
4. The blue/green LED will change to solid blue for 5 revolutions of the meter. See table LED Functions on next page for duration of compensation process. Duration is dependent upon flow rate and requires at least 10 seconds at maximum flow and 90 seconds at minimum flow.
5. A green LED light indicates a successful update of the compensation, a red LED light indicates the new compensation failed. Additional information is available through the interface software.
6. Return your system to 'operating' mode or restore settings to allow for feedback control.

Field Compensation Flow Rate Table A

| Max Flow Meter | Minimum Flow Rate (cc/min) | Maximum Flow Rate (cc/min) |
|----------------|----------------------------|----------------------------|
| G004           | 7                          | 2210                       |
| G015           | 16                         | 5155                       |
| G045           | 52                         | 16,570                     |
| G105           | 146                        | 46,640                     |
| G240           | 512                        | 163,270                    |

## LED Functions

| Normal Operation                 |                                 |  |
|----------------------------------|---------------------------------|--|
| STATUS                           | LED                             | ACTION   |
| Functioning - System Not Flowing | Blue or Green Steady            | Meter is functioning, but no flow is detected in the system.   |
| Functioning - System Flowing     | Blue / Green alternating colors | Meter is functioning, flow is occurring in the system. Note: At high flow rates the alternating Blue/Green flashes may appear as a single steady color.  |
| Meter Malfunction                | Red Steady                      | Refurbish Meter.   |
| No Power / Meter Failure         | No Light                        | <ul style="list-style-type: none"> <li>- Verify power supply to meter.</li> <li>- Verify wiring follows diagrams on page 4.</li> <li>- If power and wiring are verified, refurbish meter.</li> </ul> |

| Compensation via Interface Software Kit or Gold PCA Button   |              |   |
|--|--------------|---|
| STATUS   | LED          | ACTION  |
| Compensate button pushed/clicked   | Blue Steady  | - Steady light for 4-5 revolutions of meter.  |
| Compensation Succeeded   | Green Steady | <ul style="list-style-type: none"> <li>- Steady light for 5 seconds.</li> <li>- Software will show "Success" on screen.</li> </ul>                          |
| Compensation Failed  | Red Steady   | <ul style="list-style-type: none"> <li>- Steady light for 5 seconds.</li> <li>- Software will show "Flow too low/ too high/ unstable" on screen.</li> </ul> |
| <p>Note: Revolutions of meter are dependent on expected fluid flow rate. Per Table A, the maximum compensation flow rate will take approximately 10 seconds and the minimum compensation flow rate will take approximately 90 seconds to complete 5 revolutions at the stated flow rates.</p>                                  |              |   |
| <p>If compensation fails, restart the compensation process. When using the Interface Software Kit, follow instructions provided to correct errors prior to attempting compensation again. If problems persist, contact Max Machinery at 707-433-2662 or at <a href="http://www.maxmachinery.com">www.maxmachinery.com</a>.</p> |              |   |

# Specifications

## G004 SPECIFICATIONS

---

|                            |  |
|----------------------------|--|
| Flow Range                 | 0.5 cc/min to 4 liters/min                 |
| Accuracy (at 30 cP)        | ± 0.3% of reading over a 100:1 range       |
| Maximum Operating Pressure | 6000 psi (414 bar)                         |
| Weight                     | 1.1 kg                                     |
| Recommended Filtration     | 10 micron                                  |
| Port Size(s)               | 1/8" NPT or #4 SAE                         |
| Fluids                     | Most non-aqueous, hydrocarbon based fluids |

## MATERIALS OF CONSTRUCTION

---

|          |   |
|----------|---|
| External | Stainless Steel, type 303                                 |
| Wetted   | Stainless Steel, type 303, 440C, 17-4                     |
| O-Rings  | Standard: Viton®<br>Optional: Teflon®, Perfluoroelastomer |

## FREQUENCY TRANSMITTER

---

|   |  |
|---|--|
| Output Signal                                       | Standard: 5 Vdc, single phase<br>Optional: Quadrature 5 Vdc, two phase<br>Current sinking, 20 mA max., single phase  |
| K-Factor  | Single Phase: 500 pulses/cc<br>Two Phase: 1,000 pulses/cc, 4x decoded<br>(250 pulses/cc/phase, 1x decoded)   |
| Power Supply Requirements                           | 5 - 26 Vdc, @ 30 mA  |
| Ambient Operational Range                           | -40°C to 80°C, Single piece – Two piece to 110°C   |
| Metered Liquid Temp Range<br>(based on 20° ambient) | -40°C to 90°C, Standard model<br>-40°C to 155°C, Two piece high temperature model<br>-40°C to 225°C, Two piece ultra high temperature model                  |
| Compliance  | CE Certified, Ex-proof version available with ATEX/IECEX II 2 G Ex db IIB Tx Gb as well as UL, cUL certification for Class 1, Division 1, Groups C and D, Tx |

## ANALOG TRANSMITTER

---

|   |  |
|---|--|
| Output Signal                                       | Any range of ± 10V or ± 20mA Linearized and damped with anti-dither protection.  |
| Power Supply Requirements                           | Two Models: 12Vdc @ 90 mA, 24Vdc @ 45 mA   |
| Ambient Operational Range                           | -40°C to 80°C, Single piece – Two piece to 110°C   |
| Metered Liquid Temp Range<br>(based on 20° ambient) | -40°C to 90°C, Standard model<br>-40°C to 155°C, Two piece high temperature model<br>-40°C to 225°C, Two piece, ultra high temperature model                 |
| Compliance  | CE Certified, Ex-proof version available with ATEX/IECEX II 2 G Ex db IIB Tx Gb as well as UL, cUL certification for Class 1, Division 1, Groups C and D, Tx |



# Specifications

## G004HZ SPECIFICATIONS

---

|                            |  |
|----------------------------|--|
| Flow Range                 | 0.5 cc/min to 4 liters/min                 |
| Accuracy (at 30 cP)        | ± 0.3% of reading over a 100:1 range,      |
| Maximum Operating Pressure | 6000 psi (414 bar)                         |
| Weight                     | 1.1 kg                                     |
| Recommended Filtration     | 10 micron                                  |
| Port Size(s)               | 1/8" NPT or #4 SAE                         |
| Fluids                     | Most non-aqueous, hydrocarbon based fluids |

## MATERIALS OF CONSTRUCTION

---

|          |   |
|----------|---|
| External | Stainless Steel, type 316                                 |
| Wetted   | Stainless Steel, type 316, 440C, 17-4                     |
| O-Rings  | Standard: Viton®<br>Optional: Teflon®, Perfluoroelastomer |

## FREQUENCY TRANSMITTER

---

|   |  |
|---|--|
| Output Signal                                       | Standard: 5 Vdc, single phase<br>Optional: Quadrature 5 Vdc, two phase<br>Current sinking, 20 mA max., single phase  |
| K-Factor  | Single Phase: 500 pulses/cc<br>Two Phase: 1,000 pulses/cc, 4x decoded<br>(250 pulses/cc/phase, 1x decoded)   |
| Power Supply Requirements                           | 5 - 26 Vdc, @ 30 mA  |
| Ambient Operational Range                           | -40°C to 75°C, Single piece – Two piece to 110°C   |
| Metered Liquid Temp Range<br>(based on 20° ambient) | -40°C to 75°C, Standard model<br>-40°C to 130°C, Two piece high temperature model  |
| Compliance  | CE Certified, Ex-proof version available with ATEX/IECEX II 2 G Ex db IIB Tx Gb as well as UL, cUL certification for Class 1, Division 1, Groups C and D, Tx |

## ANALOG TRANSMITTER

---

|   |  |
|---|--|
| Output Signal                                       | Any range of ± 10V or ± 20mA Linearized and damped with anti-dither protection.  |
| Power Supply Requirements                           | Two Models: 12Vdc @ 90 mA, 24Vdc @ 45 mA   |
| Ambient Operational Range                           | -40°C to 75°C, Single piece – Two piece to 110°C   |
| Metered Liquid Temp Range<br>(based on 20° ambient) | -40°C to 75°C, Standard model<br>-40°C to 130°C, Two piece high temperature model  |
| Compliance  | CE Certified, Ex-proof version available with ATEX/IECEX II 2 G Ex db IIB Tx Gb as well as UL, cUL certification for Class 1, Division 1, Groups C and D, Tx |

# Specifications

## G015 SPECIFICATIONS

---

|                            |  |
|----------------------------|--|
| Flow Range                 | 10 cc/min to 15 liters/min                 |
| Accuracy (at 30 cP)        | ± 0.3% of reading over a 100:1 range       |
| Maximum Operating Pressure | 6000 psi (414 bar)                         |
| Weight                     | 1.8 kg                                     |
| Recommended Filtration     | 10 micron                                  |
| Port Size(s)               | 3/8" NPT or #6 SAE                         |
| Fluids                     | Most non-aqueous, hydrocarbon based fluids |

## MATERIALS OF CONSTRUCTION

---

|          |   |
|----------|---|
| External | Stainless steel, type 303                                 |
| Wetted   | Stainless steel, type 303, 440C, 17-4                     |
| O-Rings  | Standard, Viton®<br>Optional: Teflon®, Perfluoroelastomer |

## FREQUENCY TRANSMITTER

---

|   |  |
|---|--|
| Output Signal                                       | Standard: 5 Vdc, single phase<br>Optional: Quadrature 5 Vdc, two phase<br>Current sinking, 20 mA max., single phase  |
| K-Factor  | Single Phase: 200 pulses/cc<br>Two Phase: 400 pulses/cc, 4x decoded<br>(100 pulses/cc/phase, 1x decoded)   |
| Power Supply Requirements                           | 5 - 26 Vdc, @ 30 mA  |
| Ambient Operational Range                           | -40°C to 80°C, Single piece – Two piece to 110°C   |
| Metered Liquid Temp Range<br>(based on 20° ambient) | -40°C to 90°C, Standard model<br>-40°C to 155°C, Two piece high temperature model<br>-40°C to 225°C, Two piece, ultra high temperature model                 |
| Compliance  | CE Certified, Ex-proof version available with ATEX/IECEx II 2 G Ex db IIB Tx Gb as well as UL, cUL certification for Class 1, Division 1, Groups C and D, Tx |

## ANALOG TRANSMITTER

---

|   |  |
|---|--|
| Output Signal                                       | Any range of ± 10V or ± 20mA Linearized and damped with anti-dither protection.  |
| Power Supply Requirements                           | Two Models: 12Vdc @ 90 mA, 24Vdc @ 45 mA   |
| Ambient Operational Range                           | -40°C to 80°C, Single piece – Two piece to 110°C   |
| Metered Liquid Temp Range<br>(based on 20° ambient) | -40°C to 90°C, Standard model<br>-40°C to 155°C, Two piece high temperature model<br>-40°C to 225°C, Two piece, ultra high temperature model                 |
| Compliance  | CE Certified, Ex-proof version available with ATEX/IECEx II 2 G Ex db IIB Tx Gb as well as UL, cUL certification for Class 1, Division 1, Groups C and D, Tx |

# Specifications

## G015HZ SPECIFICATIONS

---

|                            |  |
|----------------------------|--|
| Flow Range                 | 10 cc/min to 15 liters/min                 |
| Accuracy (at 30 cP)        | ± 0.3% of reading over a 100:1 range       |
| Maximum Operating Pressure | 6000 psi (414 bar)                         |
| Weight                     | 1.8 kg                                     |
| Recommended Filtration     | 10 micron                                  |
| Port Size(s)               | 3/8" NPT or #6 SAE                         |
| Fluids                     | Most non-aqueous, hydrocarbon based fluids |

## MATERIALS OF CONSTRUCTION

---

|          |   |
|----------|---|
| External | Stainless steel, type 316                                 |
| Wetted   | Stainless steel, type 316, 440C, 17-4                     |
| O-Rings  | Standard, Viton®<br>Optional: Teflon®, Perfluoroelastomer |

## FREQUENCY TRANSMITTER

---

|   |  |
|---|--|
| Output Signal                                       | Standard: 5 Vdc, single phase<br>Optional: Quadrature 5 Vdc, two phase<br>Current sinking, 20 mA max., single phase  |
| K-Factor  | Single Phase: 200 pulses/cc<br>Two Phase: 400 pulses/cc, 4x decoded<br>(100 pulses/cc/phase, 1x decoded)   |
| Power Supply Requirements                           | 5 - 26 Vdc, @ 30 mA  |
| Ambient Operational Range                           | -40°C to 75°C, Single piece – Two piece to 110°C   |
| Metered Liquid Temp Range<br>(based on 20° ambient) | -40°C to 75°C, Standard model<br>-40°C to 130°C, Two piece high temperature model  |
| Compliance  | CE Certified, Ex-proof version available with ATEX/IECEx II 2 G Ex db IIB Tx Gb as well as UL, cUL certification for Class 1, Division 1, Groups C and D, Tx |

## ANALOG TRANSMITTER

---

|   |  |
|---|--|
| Output Signal                                       | Any range of ± 10V or ± 20mA Linearized and damped with anti-dither protection.  |
| Power Supply Requirements                           | Two Models: 12Vdc @ 90 mA, 24Vdc @ 45 mA   |
| Ambient Operational Range                           | -40°C to 75°C, Single piece – Two piece to 110°C   |
| Metered Liquid Temp Range<br>(based on 20° ambient) | -40°C to 75°C, Standard model<br>-40°C to 130°C, Two piece high temperature model  |
| Compliance  | CE Certified, Ex-proof version available with ATEX/IECEx II 2 G Ex db IIB Tx Gb as well as UL, cUL certification for Class 1, Division 1, Groups C and D, Tx |

# Specifications

## G045 SPECIFICATIONS

---

|                            |  |
|----------------------------|--|
| Flow Range                 | 25 cc/min to 45 liters/min                 |
| Accuracy (at 30 cP)        | ± 0.3% of reading over a 100:1 range       |
| Maximum Operating Pressure | 6000 psi (414 bar)                         |
| Weight                     | 3.7 kg                                     |
| Recommended Filtration     | 30 micron                                  |
| Port Size(s)               | 1/2" NPT or #8 SAE                         |
| Fluids                     | Most non-aqueous, hydrocarbon based fluids |

## MATERIALS OF CONSTRUCTION

---

|          |   |
|----------|---|
| External | Stainless steel, type 303                                 |
| Wetted   | Stainless steel, type 303, 440C, 17-4                     |
| O-Rings  | Standard: Viton®<br>Optional: Teflon®, Perfluoroelastomer |

## FREQUENCY TRANSMITTER

---

|   |  |
|---|--|
| Output Signal                                       | Standard: 5 Vdc, single phase<br>Optional: Quadrature 5 Vdc, two phase<br>Current sinking, 20 mA max., single phase  |
| K-Factor  | Single Phase: 70 pulses/cc<br>Two Phase: 140 pulses/cc, 4x decoded<br>(35 pulses/cc/phase, 1x decoded)   |
| Power Supply Requirements                           | 5 - 26 Vdc, @ 30 mA  |
| Ambient Operational Range                           | -40°C to 80°C, Single piece – Two piece to 110°C   |
| Metered Liquid Temp Range<br>(based on 20° ambient) | -40°C to 90°C, Standard model<br>-40°C to 155°C, Two piece high temperature model<br>-40°C to 225°C, Two piece, ultra high temperature model                 |
| Compliance  | CE Certified, Ex-proof version available with ATEX/IECEX II 2 G Ex db IIB Tx Gb as well as UL, cUL certification for Class 1, Division 1, Groups C and D, Tx |

## ANALOG TRANSMITTER

---

|   |  |
|---|--|
| Output Signal                                       | Any range of ± 10V or ± 20mA Linearized and damped with anti-dither protection.  |
| Power Supply Requirements                           | Two Models: 12Vdc @ 90 mA, 24Vdc @ 45 mA   |
| Ambient Operational Range                           | -40°C to 80°C, Single piece – Two piece to 110°C   |
| Metered Liquid Temp Range<br>(based on 20° ambient) | -40°C to 90°C, Standard model<br>-40°C to 155°C, Two piece high temperature model<br>-40°C to 225°C, Two piece, ultra high temperature model                 |
| Compliance  | CE Certified, Ex-proof version available with ATEX/IECEX II 2 G Ex db IIB Tx Gb as well as UL, cUL certification for Class 1, Division 1, Groups C and D, Tx |

# Specifications

## G045HZ SPECIFICATIONS

---

|                            |  |
|----------------------------|--|
| Flow Range                 | 25 cc/min to 45 liters/min                 |
| Accuracy (at 30 cP)        | ± 0.3% of reading over a 100:1 range       |
| Maximum Operating Pressure | 6000 psi (414 bar)                         |
| Weight                     | 3.7 kg                                     |
| Recommended Filtration     | 30 micron                                  |
| Port Size(s)               | 1/2" NPT or #8 SAE                         |
| Fluids                     | Most non-aqueous, hydrocarbon based fluids |

## MATERIALS OF CONSTRUCTION

---

|          |   |
|----------|---|
| External | Stainless steel, type 316                                 |
| Wetted   | Stainless steel, type 316, 440C, 17-4                     |
| O-Rings  | Standard: Viton®<br>Optional: Teflon®, Perfluoroelastomer |

## FREQUENCY TRANSMITTER

---

|   |  |
|---|--|
| Output Signal                                       | Standard: 5 Vdc, single phase<br>Optional: Quadrature 5 Vdc, two phase<br>Current sinking, 20 mA max., single phase  |
| K-Factor  | Single Phase: 70 pulses/cc<br>Two Phase: 140 pulses/cc, 4x decoded<br>(35 pulses/cc/phase, 1x decoded)   |
| Power Supply Requirements                           | 5 - 26 Vdc, @ 30 mA  |
| Ambient Operational Range                           | -40°C to 75°C, Single piece – Two piece to 110°C   |
| Metered Liquid Temp Range<br>(based on 20° ambient) | -40°C to 75°C, Standard model<br>-40°C to 130°C, Two piece high temperature model  |
| Compliance  | CE Certified, Ex-proof version available with ATEX/IECEX II 2 G Ex db IIB Tx Gb as well as UL, cUL certification for Class 1, Division 1, Groups C and D, Tx |

## ANALOG TRANSMITTER

---

|   |  |
|---|--|
| Output Signal                                       | Any range of ± 10V or ± 20mA Linearized and damped with anti-dither protection.  |
| Power Supply Requirements                           | Two Models: 12Vdc @ 90 mA, 24Vdc @ 45 mA   |
| Ambient Operational Range                           | -40°C to 75°C, Single piece – Two piece to 110°C   |
| Metered Liquid Temp Range<br>(based on 20° ambient) | -40°C to 75°C, Standard model<br>-40°C to 130°C, Two piece high temperature model  |
| Compliance  | CE Certified, Ex-proof version available with ATEX/IECEX II 2 G Ex db IIB Tx Gb as well as UL, cUL certification for Class 1, Division 1, Groups C and D, Tx |

# Specifications

## G105 SPECIFICATIONS

---

|                            |  |
|----------------------------|--|
| Flow Range                 | 75 cc/min to 105 liters/min                |
| Accuracy (at 30 cP)        | ± 0.3% of reading over a 100:1 range       |
| Maximum Operating Pressure | 6000 psi (414 bar)                         |
| Weight                     | 7.7 kg                                     |
| Recommended Filtration     | 30 micron                                  |
| Port Size(s)               | 3/4" NPT or #10 SAE                        |
| Fluids                     | Most non-aqueous, hydrocarbon based fluids |

## MATERIALS OF CONSTRUCTION

---

|          |   |
|----------|---|
| External | Stainless steel, type 303                                 |
| Wetted   | Stainless steel, type 303, 440C, 17-4                     |
| O-Rings  | Standard, Viton®<br>Optional: Teflon®, Perfluoroelastomer |

## FREQUENCY TRANSMITTER

---

|   |  |
|---|--|
| Output Signal                                       | Standard: 5 Vdc, single phase<br>Optional: Quadrature 5 Vdc, two phase<br>Current sinking, 20 mA max., single phase  |
| K-Factor  | Single Phase: 25 pulses/cc<br>Two Phase: 50 pulses/cc, 4x decoded<br>(12.5 pulses/cc/phase, 1x decoded)  |
| Power Supply Requirements                           | 5 - 26 Vdc, @ 30 mA  |
| Ambient Operational Range                           | -40°C to 80°C, Single piece – Two piece to 110°C   |
| Metered Liquid Temp Range<br>(based on 20° ambient) | -40°C to 90°C, Standard model<br>-40°C to 155°C, Two piece high temperature model<br>-40°C to 225°C, Two piece, ultra high temperature model                 |
| Compliance  | CE Certified, Ex-proof version available with ATEX/IECEx II 2 G Ex db IIB Tx Gb as well as UL, cUL certification for Class 1, Division 1, Groups C and D, Tx |

## ANALOG TRANSMITTER

---

|   |  |
|---|--|
| Output Signal                                       | Any range of ± 10V or ± 20mA Linearized and damped with anti-dither protection.  |
| Power Supply Requirements                           | Two Models: 12Vdc @ 90 mA, 24Vdc @ 45 mA   |
| Ambient Operational Range                           | -40°C to 80°C, Single piece – Two piece to 110°C   |
| Metered Liquid Temp Range<br>(based on 20° ambient) | -40°C to 90°C, Standard model<br>-40°C to 155°C, Two piece high temperature model<br>-40°C to 225°C, Two piece, ultra high temperature model                 |
| Compliance  | CE Certified, Ex-proof version available with ATEX/IECEx II 2 G Ex db IIB Tx Gb as well as UL, cUL certification for Class 1, Division 1, Groups C and D, Tx |

# Specifications

## G240 SPECIFICATIONS

---

|                            |  |
|----------------------------|--|
| Flow Range                 | 250 cc/min to 240 liters/min   |
| Accuracy (at 30 cP)        | ± 0.3% of reading over a 100:1 range                                   |
| Maximum Operating Pressure | 4000 psi (275 bar) - NPT fittings<br>6000 psi (414 bar) - SAE fittings |
| Weight                     | 21 kg  |
| Recommended Filtration     | 30 micron  |
| Port Size(s)               | 1" NPT or #16 SAE  |
| Fluids                     | Most non-aqueous, hydrocarbon based fluids                             |

## MATERIALS OF CONSTRUCTION

---

|                  |   |
|------------------|---|
| Body             | Stainless steel, type 303                                 |
| Gears and Shafts | Stainless steel, type 303, 440C, 17-4                     |
| O-Rings          | Standard, Viton®<br>Optional: Teflon®, Perfluoroelastomer |

## FREQUENCY TRANSMITTER

---

|   |  |
|---|--|
| Output Signal                                       | Standard: 5 Vdc, single phase<br>Optional: Quadrature 5 Vdc, two phase<br>Current sinking, 20 mA max., single phase  |
| K-Factor  | Single Phase: 7 pulses/cc<br>Two Phase: 14 pulses/cc, 4x decoded<br>(3.5 pulses/cc/phase, 1x decoded)  |
| Power Supply Requirements                           | 5 - 26 Vdc, @ 30 mA  |
| Ambient Operational Range                           | -40°C to 80°C, Single piece – Two piece to 110°C   |
| Metered Liquid Temp Range<br>(based on 20° ambient) | -40°C to 90°C, Standard model<br>-40°C to 155°C, Two piece high temperature model<br>-40°C to 225°C, Two piece, ultra high temperature model                 |
| Compliance  | CE Certified, Ex-proof version available with ATEX/IECEx II 2 G Ex db IIB Tx Gb as well as UL, cUL certification for Class 1, Division 1, Groups C and D, Tx |

## ANALOG TRANSMITTER

---

|   |  |
|---|--|
| Output Signal                                       | Any range of ± 10V or ± 20mA Linearized and damped with anti-dither protection.  |
| Power Supply Requirements                           | Two Models: 12Vdc @ 90 mA, 24Vdc @ 45 mA   |
| Ambient Operational Range                           | -40°C to 80°C, Single piece – Two piece to 110°C   |
| Metered Liquid Temp Range<br>(based on 20° ambient) | -40°C to 90°C, Standard model<br>-40°C to 155°C, Two piece high temperature model<br>-40°C to 225°C, Two piece, ultra high temperature model                 |
| Compliance  | CE Certified, Ex-proof version available with ATEX/IECEx II 2 G Ex db IIB Tx Gb as well as UL, cUL certification for Class 1, Division 1, Groups C and D, Tx |

# Dimensions

## G004 SPECIFICATIONS

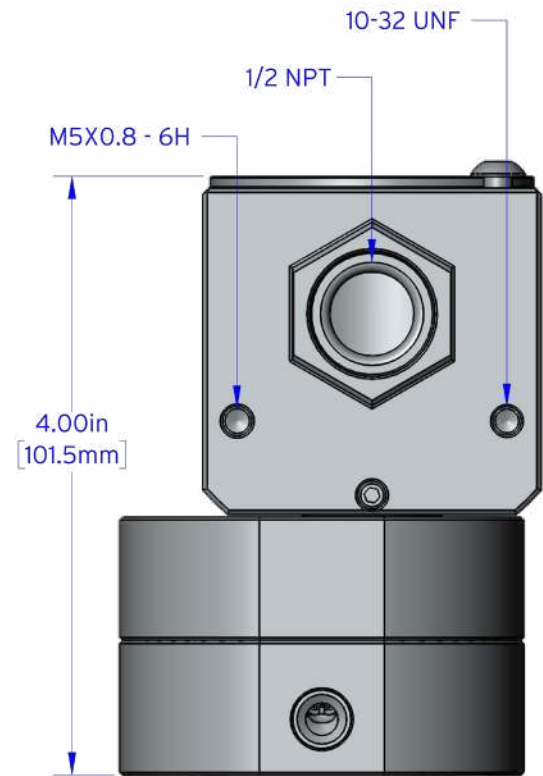
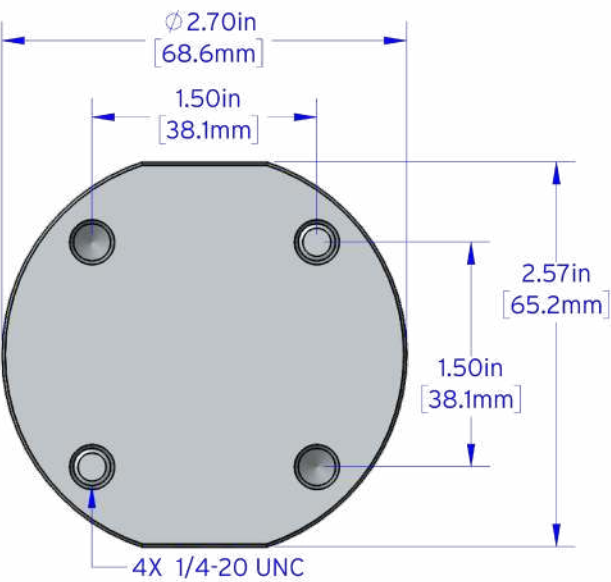
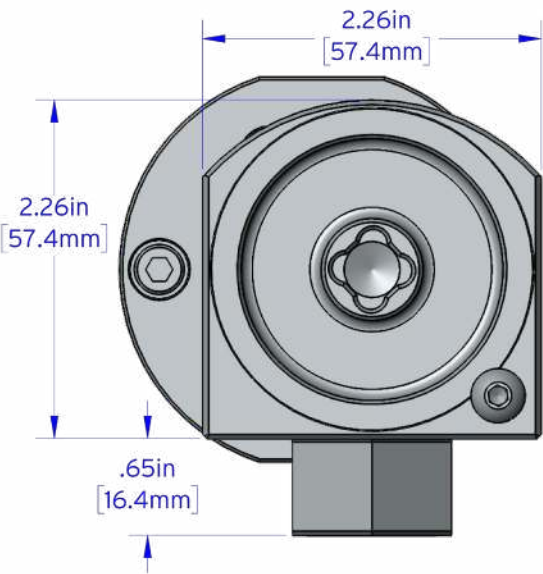
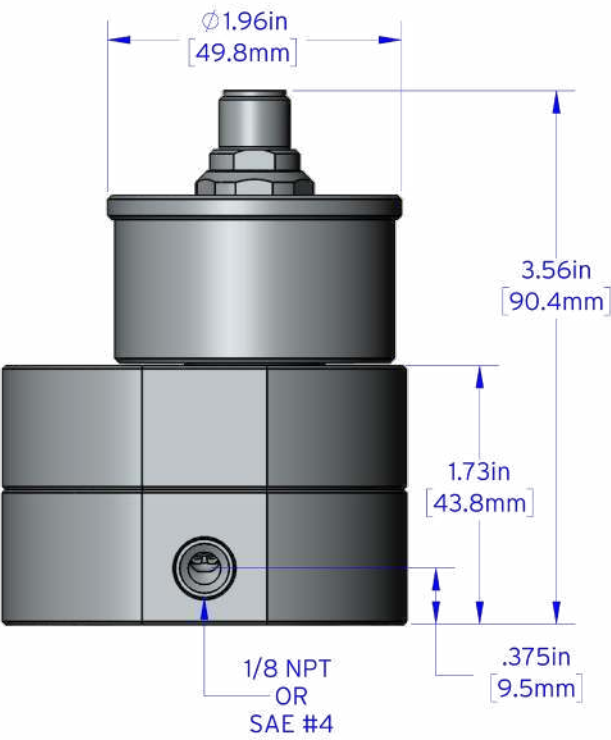



# Dimensions

## G004HZ SPECIFICATIONS

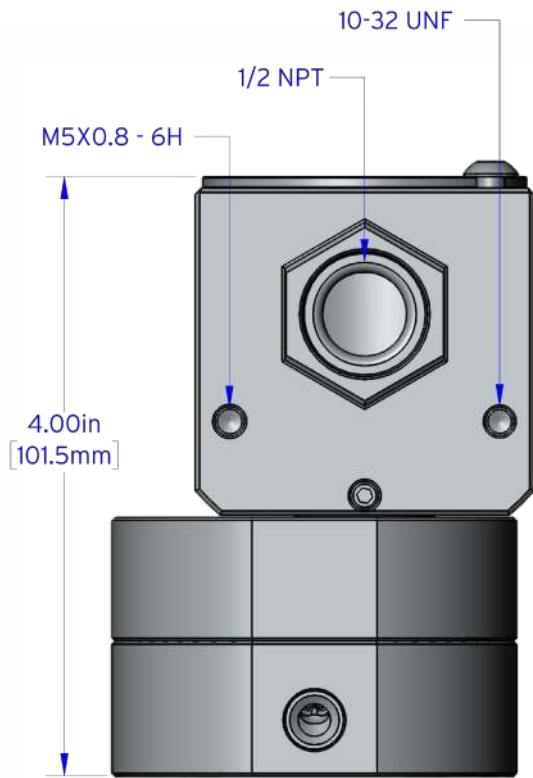

MODEL G004HZ WITH  
EX-PROOF HOUSING

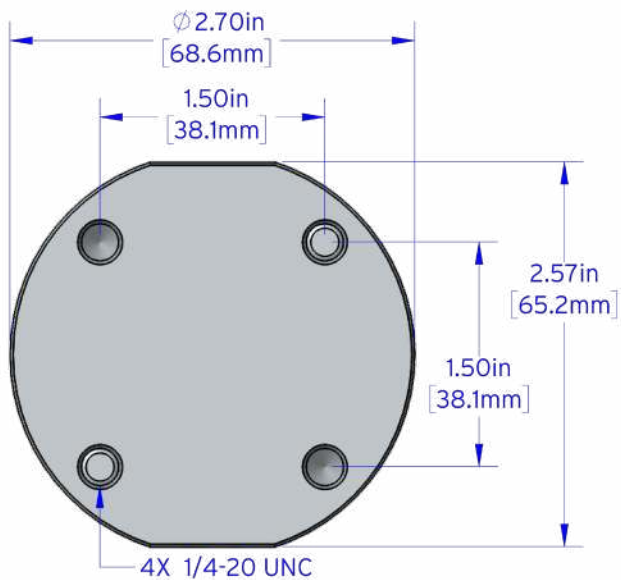
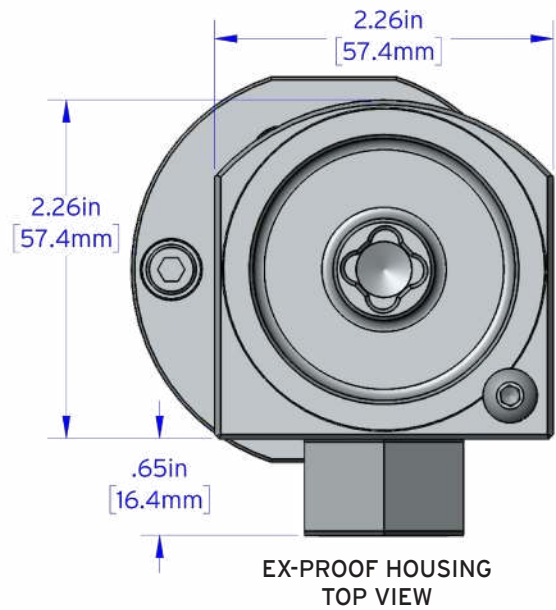

# Dimensions

## G015 SPECIFICATIONS

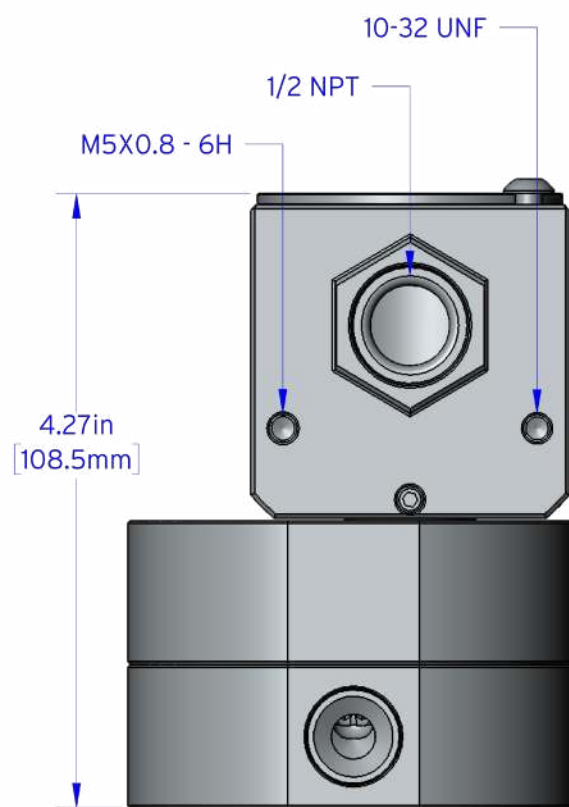
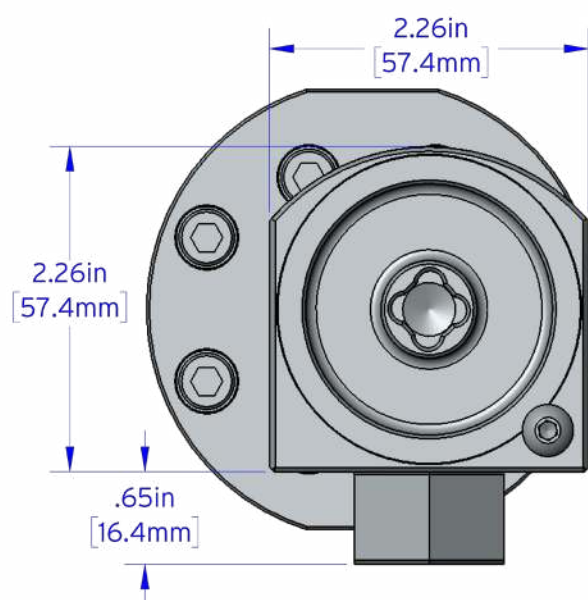
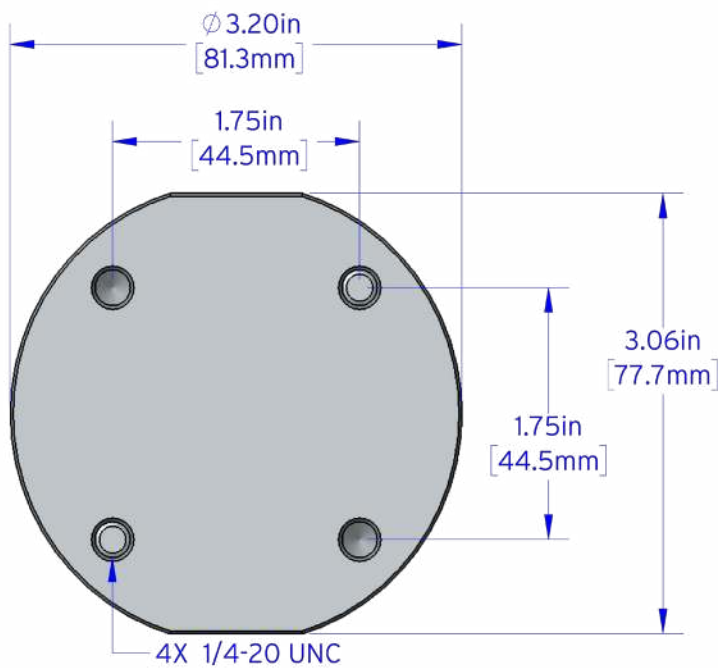
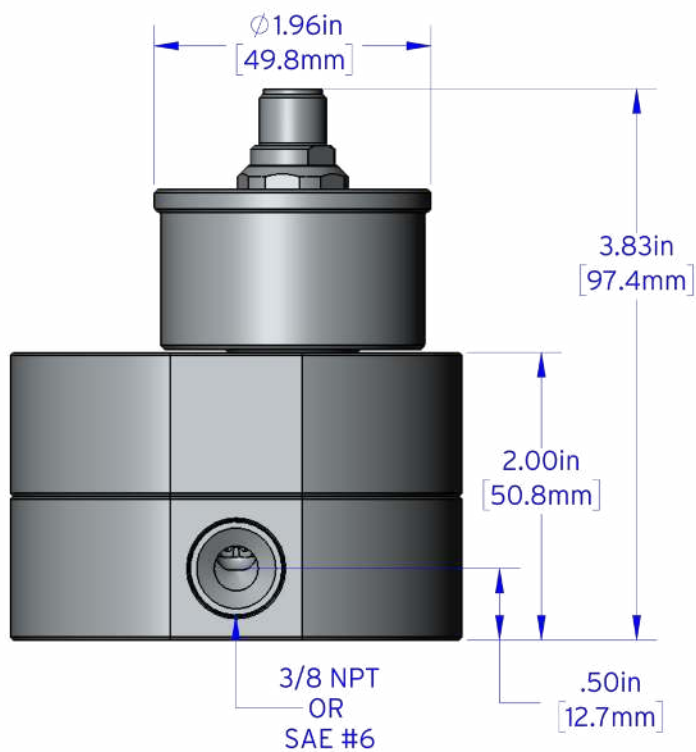

# Dimensions

## G015HZ SPECIFICATIONS

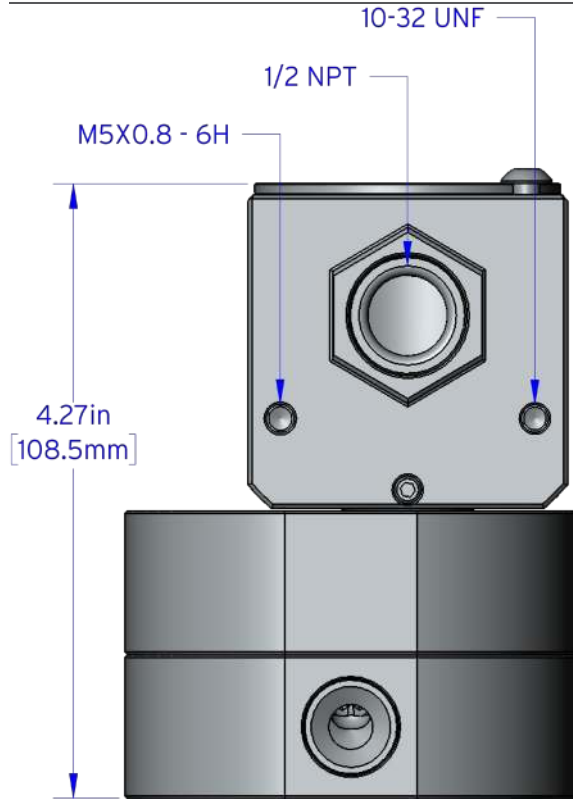

MODEL G015HZ WITH  
EX-PROOF HOUSING

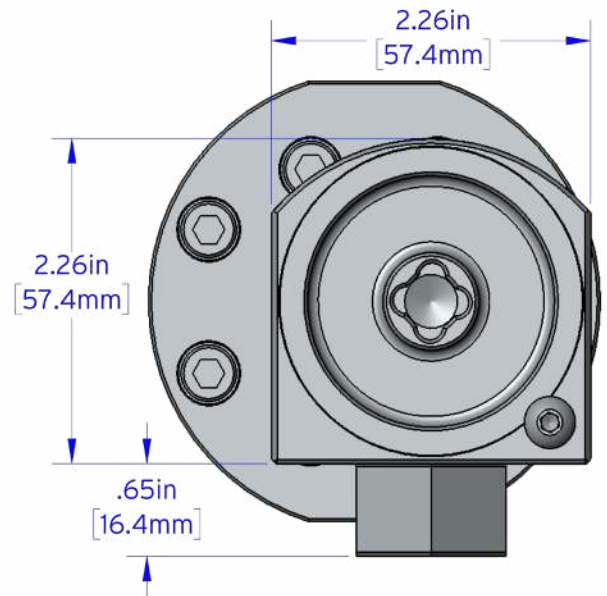

EX-PROOF HOUSING  
TOP VIEW

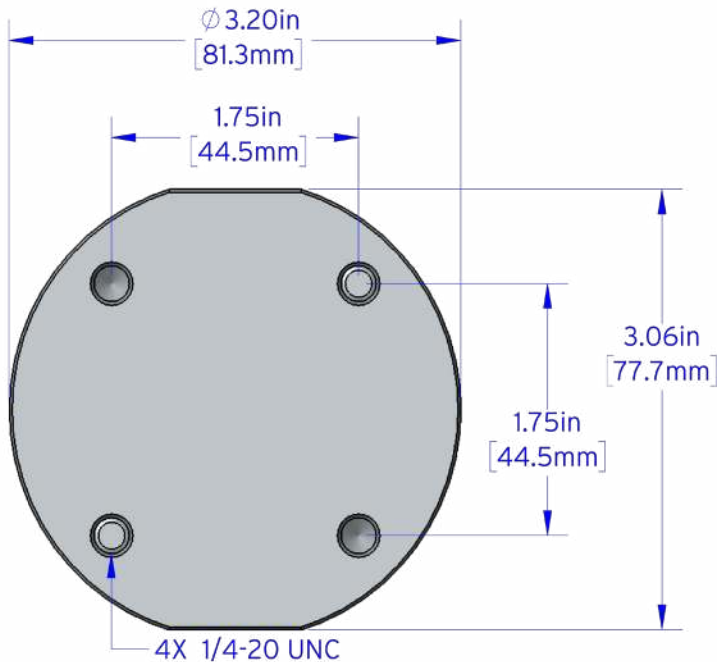

# Dimensions

## G045 SPECIFICATIONS

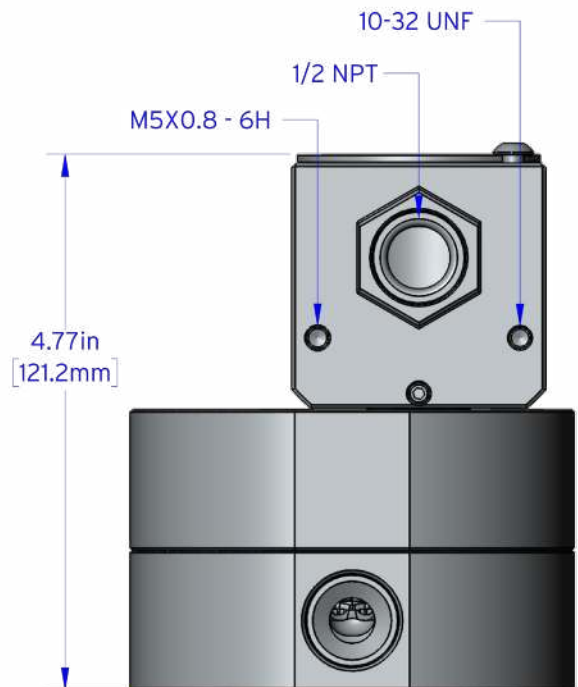
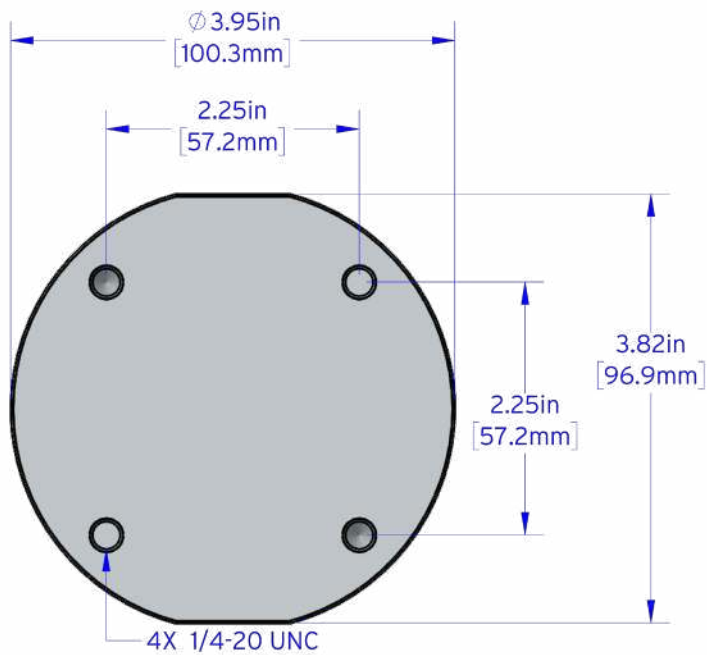
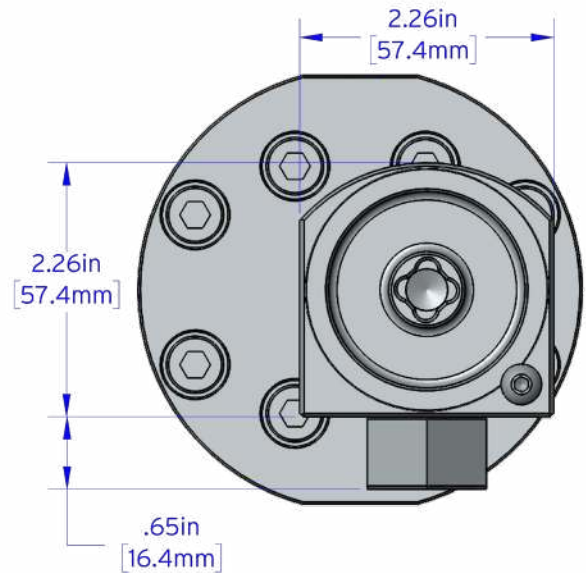
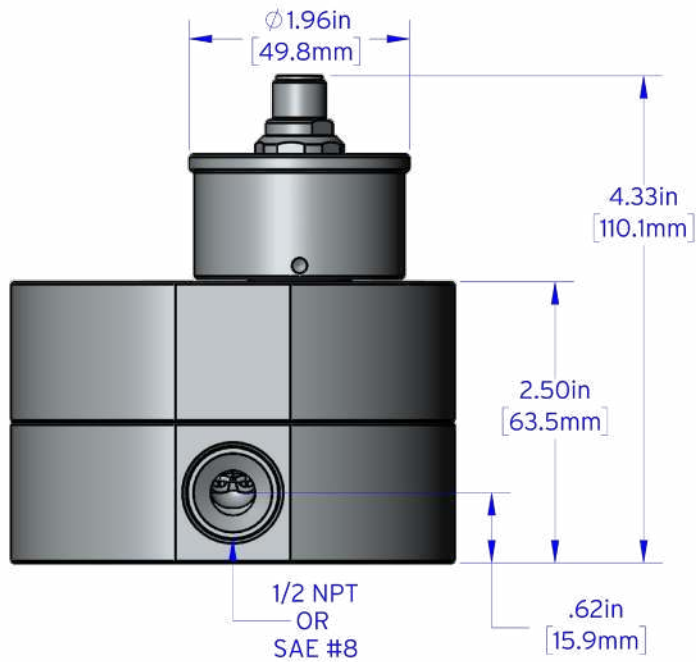

# Dimensions

## G045HZ SPECIFICATIONS

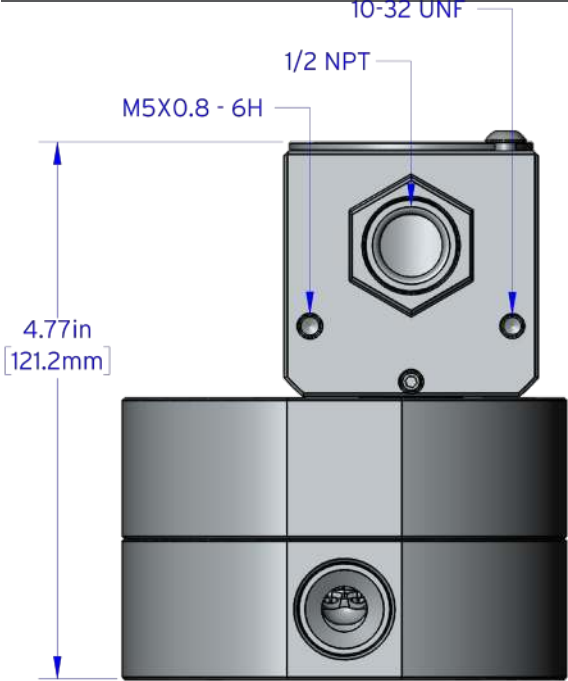

MODEL G045HZ WITH  
EX-PROOF HOUSING

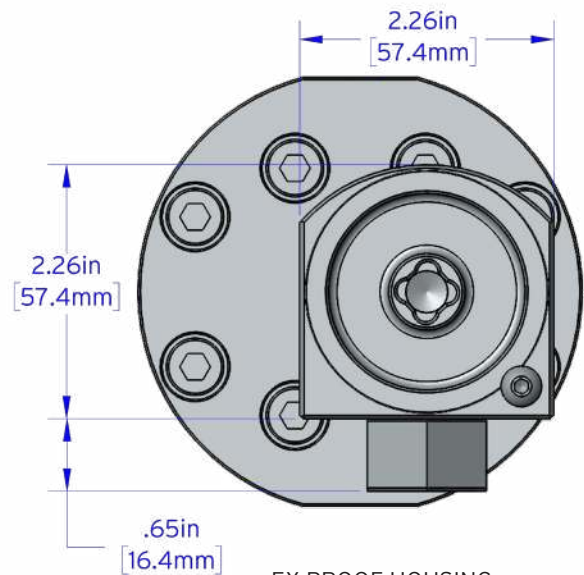

EX-PROOF HOUSING  
TOP VIEW

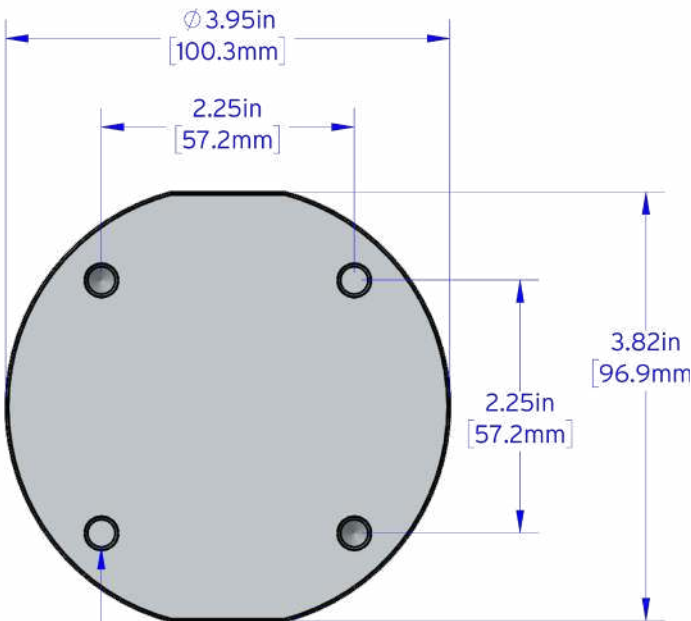

4X 1/4-20 UNC  
BOTTOM VIEW

# Dimensions

## G105 SPECIFICATIONS

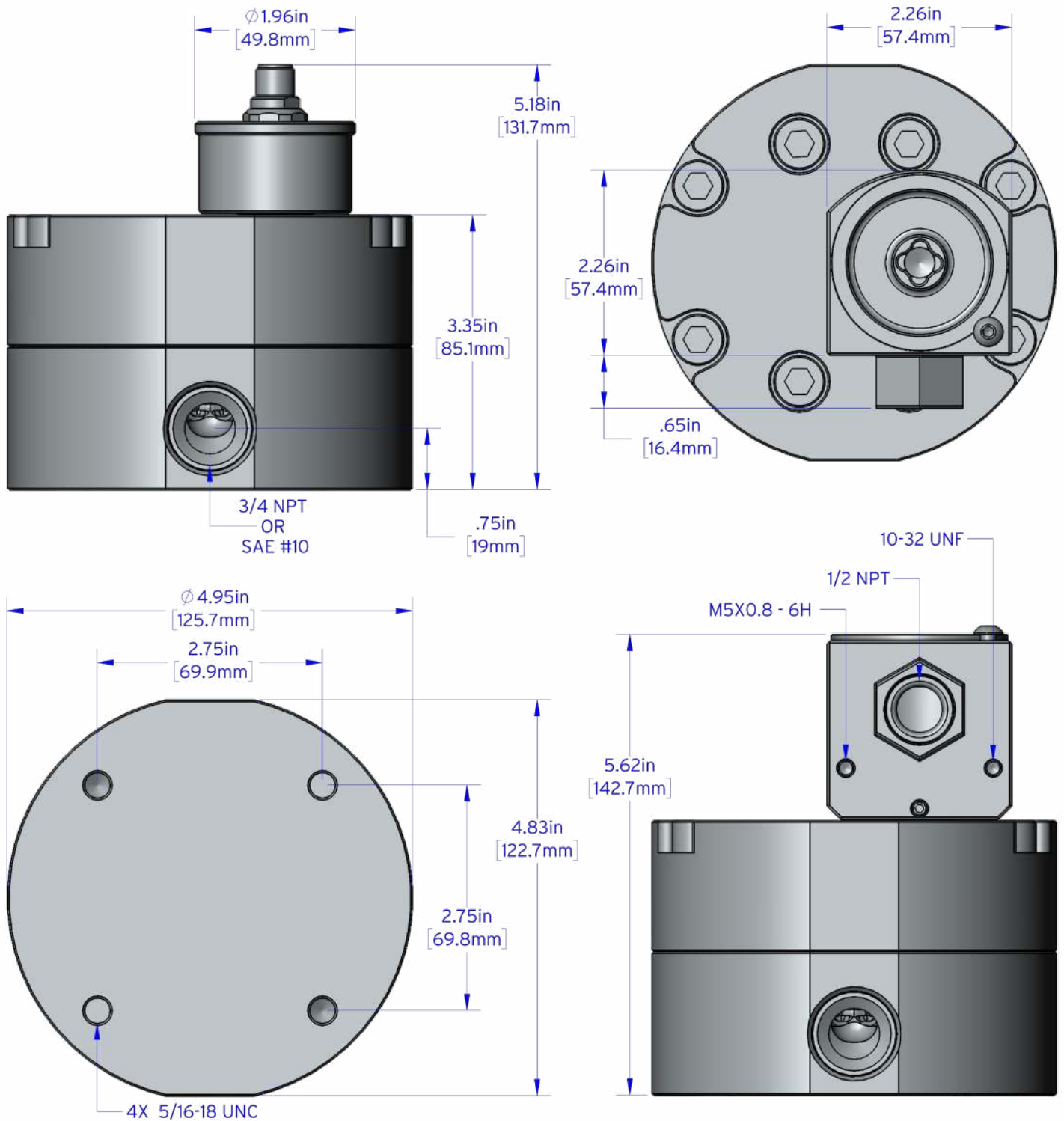



# Dimensions

## G240 SPECIFICATIONS

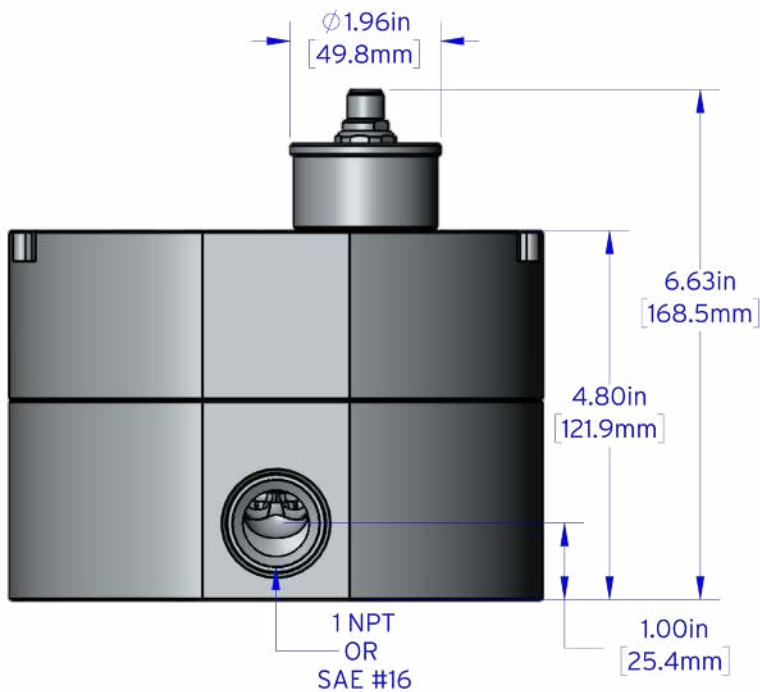

MODEL G240 WITH INDUSTRIAL HOUSING

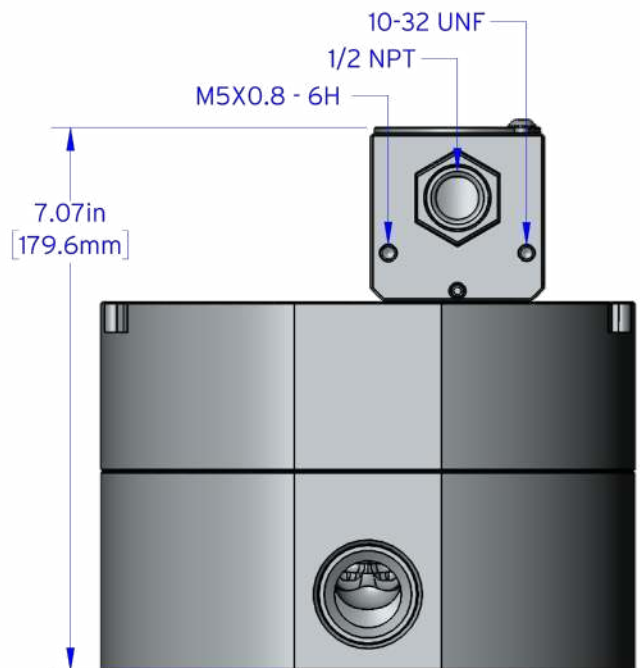
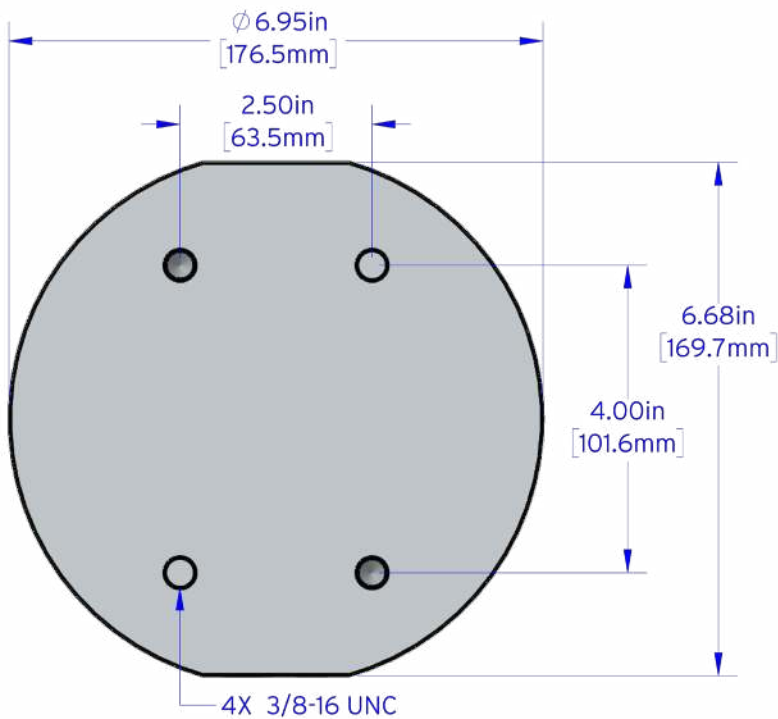
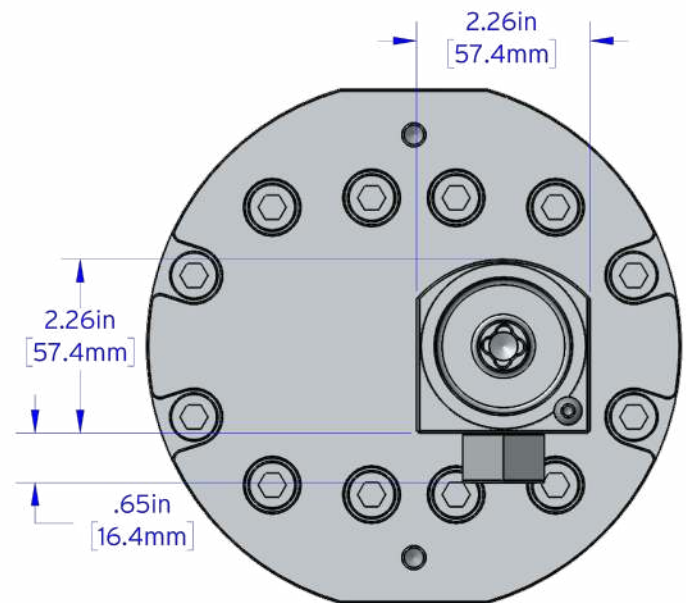

## Dimensions

### REMOTE PCA ENCLOSURE SPECIFICATIONS

---

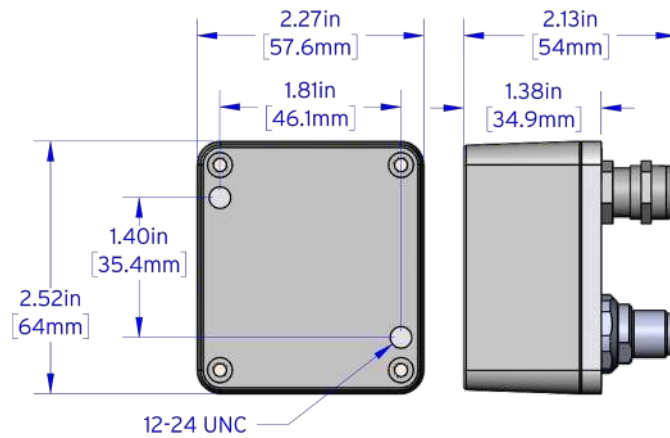

REMOTE PCA ENCLOSURE FOR HIGH  
TEMPERATURE TRANSMITTERS  
(Not Shown: Industrial 2 meter interconnect cable included,  
Ex-Proof user supplied interconnect cable required)



## Optional Heater Block

### Temperature probe holes (all models)

1/8" NPT

1/16" NPT

### Liquid trace ports

G004, G015 1/4" NPT

G045, G105 3/8" NPT

G240 (Qty 2) 3/8" NPT

### Electric Cartridge requirements

G004 3/8" x 1"

G015 3/8" x 1.3"

G045 1/2" x 2.1"

G105 1/2" x 3.1"

G240 (Qty 2) 1/2" x 4.7"

Heater block for G015  
(typical)

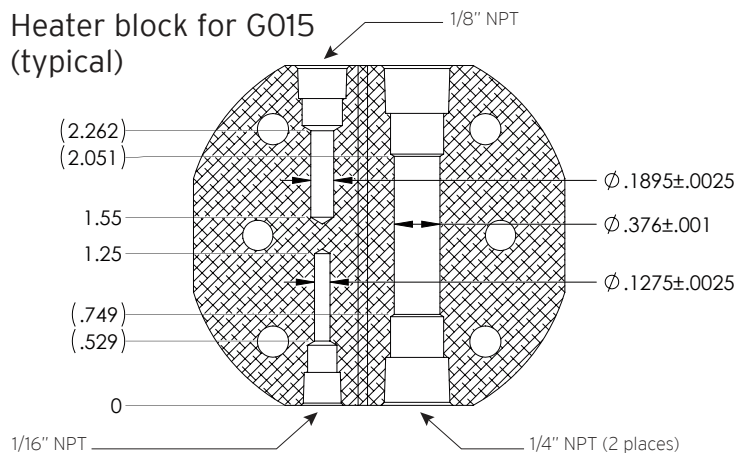

NOTES:

1: HEATER PORT CLEARANCE IS FOR A PROBE WITH 250 WATT/DENSITY MAX AT 400° F

Charts

G004 / G004HZ Pressure Drop Graph

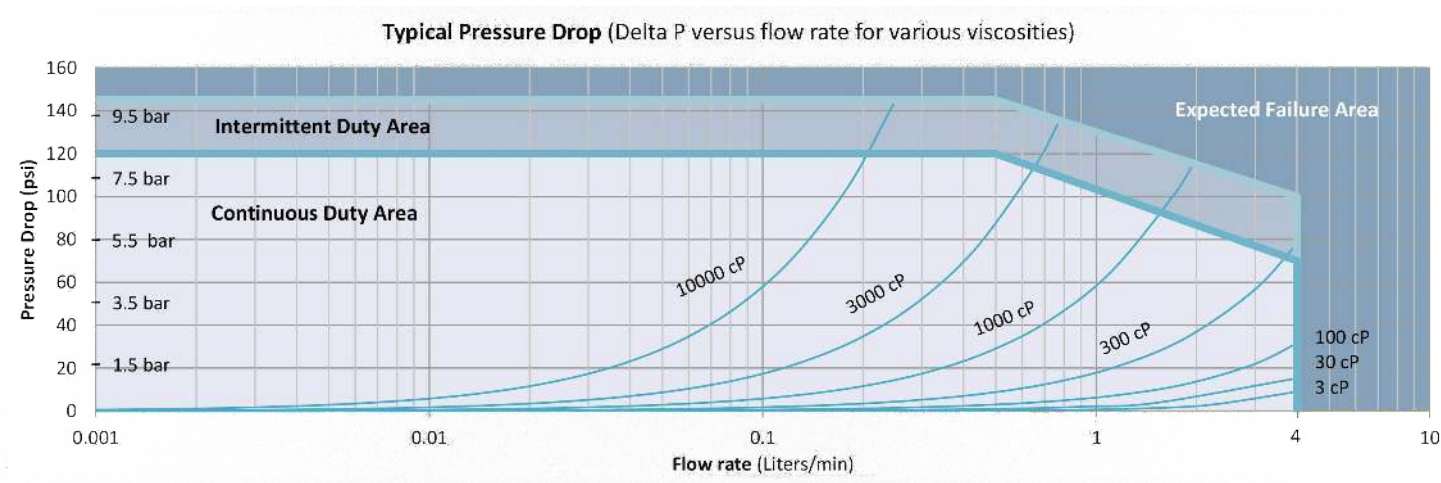

G015 / G015HZ Pressure Drop Graph

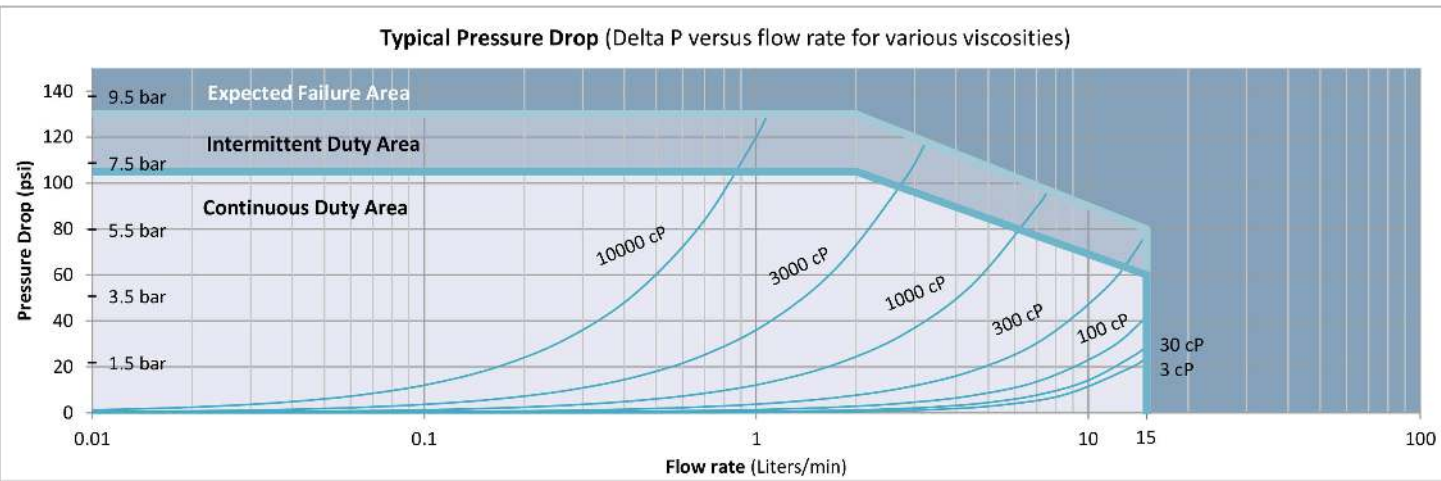

G045 / G045HZ Pressure Drop Graph

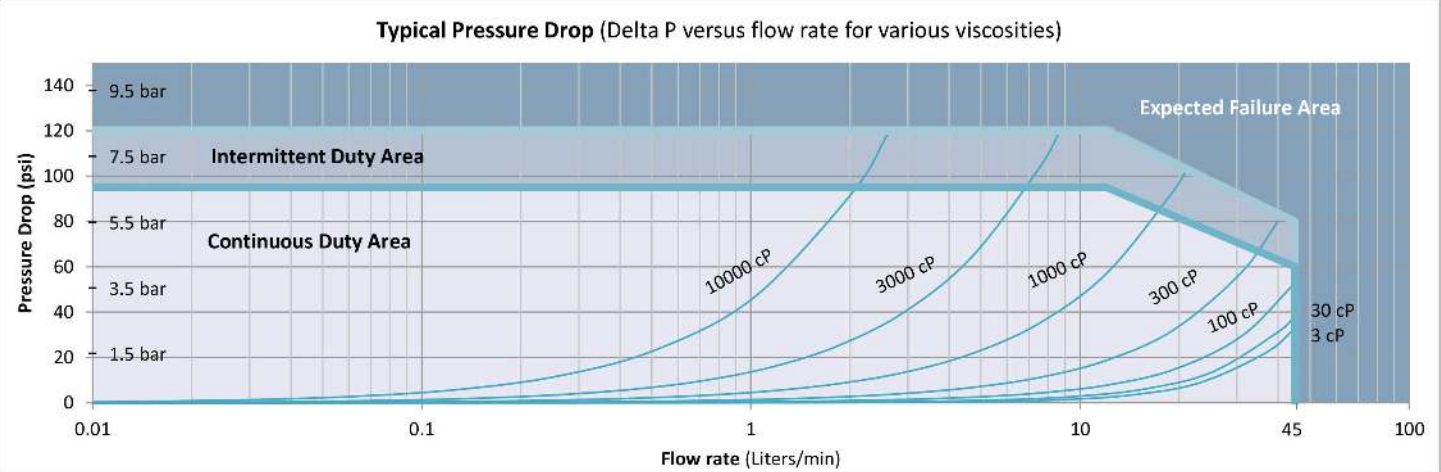

Charts

G105 Pressure Drop Graph

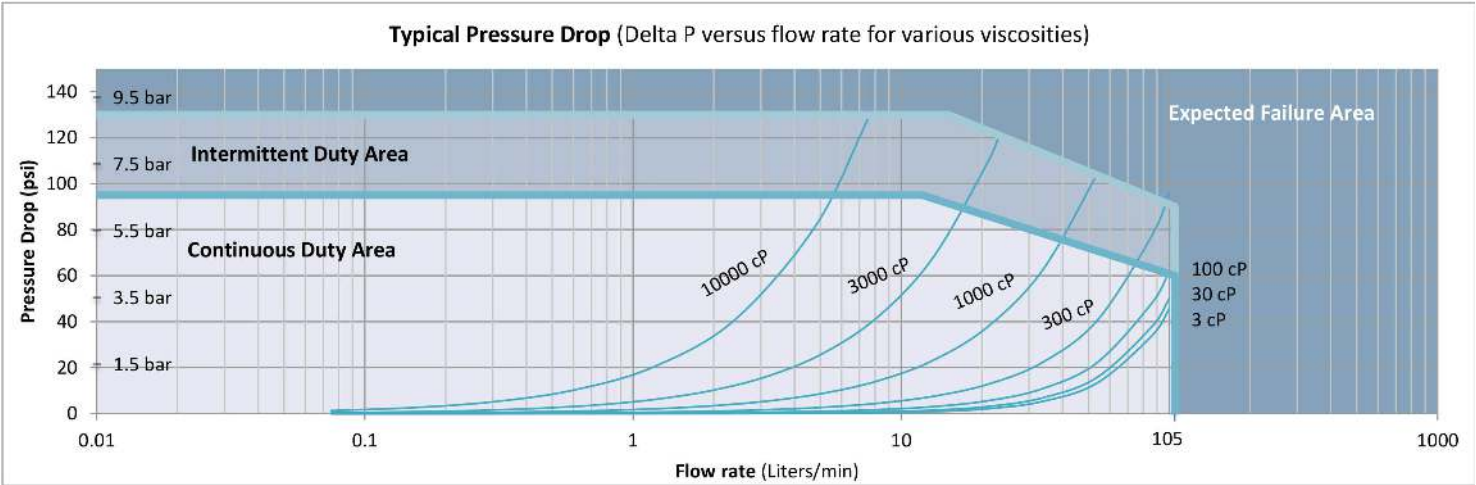

G240 Pressure Drop Graph

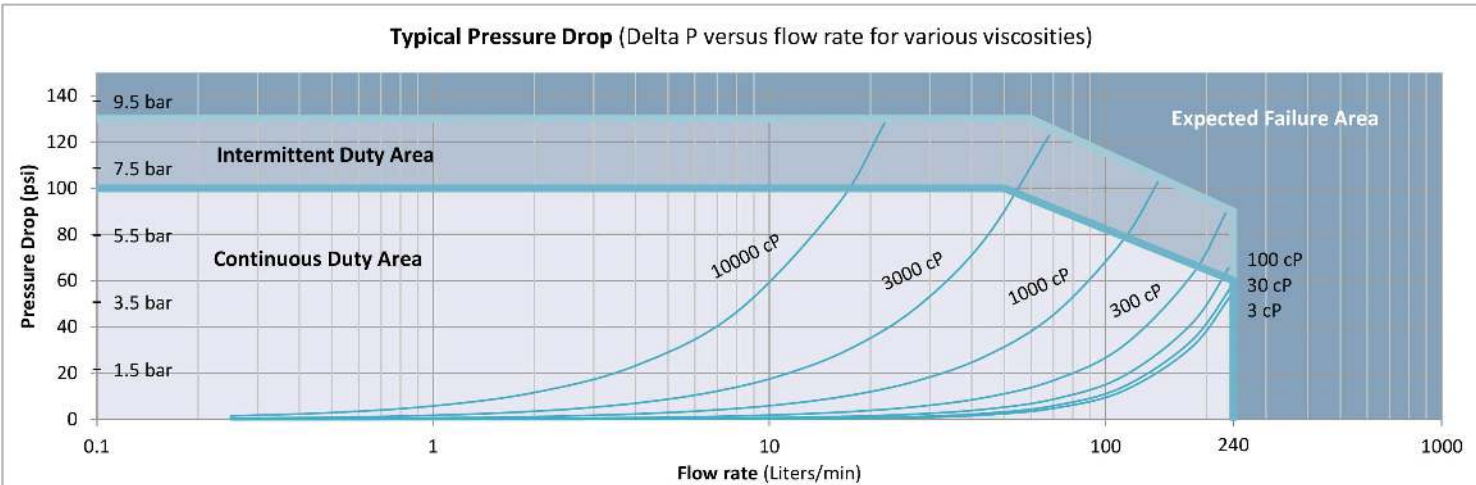



Max Machinery, Inc.  
an ISO 9001:2015 certified company

## Positive Displacement Flow Meters Gear Type, G-Series

Flow Meter Selections      Transmitter Selections

Model #   HS    /     / 1 -  Non-Standard Options

### Max Flow Range

|                |      |
|----------------|------|
| 4 Liters/Min   | G004 |
| 15 Liters/Min  | G015 |
| 45 Liters/Min  | G045 |
| 105 Liters/Min | G105 |
| 240 Liters/Min | G240 |

### Pressure

6000 psi (414 bar) HS

Note: G240 limited to 4000 psi (240 bar)  
if specified with NPT connections

### Fluid Connection

|     |   |
|-----|---|
| NPT | 1 |
| SAE | 2 |

### Seal Selection

|                           |   |
|---------------------------|---|
| Viton® - FKM              | 1 |
| Teflon® - PTFE***         | 3 |
| Perfluoroelastomer - FFKM | 5 |

### Options

|                   |    |
|-------------------|----|
| None              | NA |
| Heat Trace Option | HT |

### 1 Transmitter Type

### Output Type

|   |   |                                      |
|---|---|--------------------------------------|
| A | A | 4-20mA Output - Powered by 24 Vdc    |
| A | B | 4-20mA Output - Powered by 12 Vdc    |
| A | C | 0-10 Volt Output - Powered by 24 Vdc |
| A | D | 0-10 Volt Output - Powered by 12 Vdc |
| P | N | 5V Pulse/Freq. - Powered by 5-26 Vdc |
| Q | N | 5V Quadrature - Powered by 5-26 Vdc  |
| P | S | Current Sinking, Single Phase        |

### Temperature Rating

- 1 90°C Industrial / 75°C Haz-Loc
- 2 155°C Ind. / 130°C Haz-Loc, 2 Part \*\*
- 3 225°C Industrial, 2 Part †

### Electrical Connection

- 1 Industrial, Turck® Connector
- 2 Hazardous Location, 1/2 Inch Conduit\*

### Signal Type

|   |            |
|---|------------|
| P | Pulse      |
| A | Analog     |
| Q | Quadrature |



Model G015

\* See temp chart in product manual.

\*\* Receiver portion of 2 part transmitters are not rated Ex-Proof, consult factory.

\*\*\* Teflon® not used above 90°C for this high pressure rated product.

† Not available for hazardous location use. (Exceeds 130°C temp. limit.)

Product includes single directional calibration, bi-directional calibrations for analog and quadrature devices are optional.

Max Machinery, Inc.  
33A Healdsburg Avenue  
Healdsburg, CA 95448

maxmachinery.com  
T +1 707.433.2662

©2008-2021

**max**  
Precision Flow Meters



Max Machinery, Inc.  
an ISO 9001:2015 certified company

## Positive Displacement Flow Meters Gear Type, G-Series, 316 Stainless Steel

Flow Meter Selections      Transmitter Selections

Model #   HZ 1   NA /  2   / 1 -  Non-Standard Options

### Max Flow Range

4 Liters/Min    G004  
15 Liters/Min   G015  
45 Liters/Min   G045

### Pressure

6000 psi (414 bar)    HZ

### Fluid Connection

NPT 1

### Seal Selection

Viton® - FKM    1  
Teflon® - PTFE\*\*\*    3  
Perfluoroelastomer - FFKM    5

### Options

None    NA

### 1 Transmitter Type

### Output Type

|   |   |                                      |
|---|---|--------------------------------------|
| A | A | 4-20mA Output - Powered by 24 Vdc    |
| A | B | 4-20mA Output - Powered by 12 Vdc    |
| A | C | 0-10 Volt Output - Powered by 24 Vdc |
| A | D | 0-10 Volt Output - Powered by 12 Vdc |
| P | N | 5V Pulse/Freq. - Powered by 5-26 Vdc |
| Q | N | 5V Quadrature - Powered by 5-26 Vdc  |
| P | S | Current Sinking, Single Phase        |

### Temperature Rating

1 75°C Haz-Loc  
2 130°C Haz-Loc, 2 Part\*\*

### Electrical Connection

2 Hazardous Location, 1/2 Inch Conduit\*

### Signal Type

P Pulse  
A Analog  
Q Quadrature



Model G045HZ

\* See temp chart in product manual.

\*\* Receiver portion of 2 part transmitters are not rated Ex-Proof, consult factory.

\*\*\* Teflon® not used above 90°C for this high pressure rated product.

Product includes single directional calibration, bi-directional calibrations for analog and quadrature devices are optional.

Max Machinery, Inc.  
33A Healdsburg Avenue  
Healdsburg, CA 95448

maxmachinery.com  
T +1 707.433.2662

©2008-2021

**max**  
Precision Flow Meters



# Available Accessories

Accessories to support your system and simplify your installation and maintenance are available direct from Max. Request yours when you order your flow meter. See the website for information and options.

## Interface Software Kit

| Part #      | Description  |
|-------------|--|
| SFT-KIT-001 | USB drive transmitter programming software and serial cable. The following adjustments may be made to the signal output: Pulse Output Scaling, Analog Output Limits and Scaling, Signal Filtering Options and Compensation settings. |



## Cables

| Part #      | Description                           |
|-------------|---------------------------------------|
| 181-294-060 | 7 meter cable - 5-pin Turck® to wire  |
| 181-294-061 | 15 meter cable - 5-pin Turck® to wire |

Additional cable lengths available on the Max website.



## Model 122 Combination Rate Indicator/Totalizers 110/220 Vac powered (frequency input)

| Model       | Description   |
|-------------|---|
| 122-200-000 | Panel mount indicator with dual-line, 6-digit display (0.6" and 0.46"). Produces an isolated 4-20mA analog output. Provides 24 Vdc transmitter power. Can be programmed to show rate, total and/or grand total. Initial programming included as default or customer specified values. |



## F381 Series Filters and Filter Element Kits

| Model         | Description  |
|---------------|--|
| F381 - Varies | Inline filter with 5, 10, 30 micron element options. O-rings options available to match your flow meter and system requirements. |
| 381- Varies   | Filter element replacement kit with 5, 10, 30 micron element and o-ring options to match your filter.                            |



## PCA Replacement Kits

| Model  | Description  |
|--------|--|
| Varies | PCA Replacement Kits are sold for the specific serial number located on your Max Precision Flow Meter. Contact Max technical support for ordering details and to get your quote. |



## Troubleshooting and Service Request

| Problem  | Corrective Action   |
|--|---|
| No Flow through meter or high pressure drop across meter |   |
| Solidified material blocking rotation                    | Heat meter to melt material. Do not exceed maximum meter operating temperature.   |
| Debris damage or internally clogged                      | Refurbish meter.  |
| Meter broken   | Refurbish meter.  |
| Fluid passes through meter, but no flow is indicated     |   |
| Transmitter cable or conduit cable incorrectly wired     | Verify DC power is present at the PCA. Use a multi-meter to measure the transmitter output independent of the display or PLC.   |
| Meter not turning  | Refurbish meter.  |
| Indicated flow does not agree with expected readings     |   |
| Air in the line  | Air bubbles displace the meter just like a liquid. If you see over-reporting, purge all air from lines.   |
| Indicator not calibrated properly                        | Verify K-Factor for the meter in use and compare this value to the setting used in the display.   |
| Excessive reverse flow in system                         | Max transmitters' anti-dither function buffers up to 1 revolution of reverse flow. An incorrect flow total can be reported if the system reverse flow is greater than 1 meter revolution. |

## Additional Information Available

MMI provides refurbishment and calibration services. For more details or to submit your Service Request, go to <https://www.maxmachinery.com/services/>.

Additional information about our products, including STEP files and Sample Calibration sheets, may be found on our website at <https://www.maxmachinery.com/downloads/>.

MMI products are covered under our standard manufacturer's warranty. Details may be found at <https://www.maxmachinery.com/warranty/>.